

TATSFIELD PARISH COUNCIL

Minutes of Meeting of Tatsfield Parish Council held at Tatsfield School on Monday 14th January 1985 at 8 p.m.

Present Miss Garnham, Mrs. McHugo, Mr. Payne in the chair, Mrs. Player, Mr. Reeve, Dr. South, the clerk and four parishioners.

1. Apologies for Absence Mr. Shaw's absence approved by Council.
2. Minutes of Meeting held on December 10th 1984 confirmed & signed. Proposed by Mrs. McHugo, seconded by Mrs. Player.
3. Matters Arising
 - a. Planning Applications
 - i. Rose Cott. Westmore Green (3a i) Rubble on Green. Owner to restore Green on completion of building work.
 - ii. Porziuncular, Parkwood Rd. (3a ii) Change of use of garage & erection of new att. dbble. garage. Permission refused.
 - iii. Maybank, Old Lane (3a iii) Amendment to re-site garages. Plans approved. Houses to be built on bank with garages projecting forward of main building at road level.
 - iv. Grounds of Hermes, Paynesfield Rd. (3a iv) Erection of det. dwelling & garage. Nothing Further.
 - v. Land at Kylemore, Paynesfield Rd. (3a v) Erection of det. house. Nothing Further.
 - vi. Park Farm, Rag Hill (3a vii) Erection of farm house. Nothing Further.
 - vii. 84/1110 Outline. Land east of Manor House fronting Manor Rd. Erection of det. house & garage. J. Crowther, Manor House. Objections: Green Belt; violates Surrey Structure Plan; does not lie in recommended village development area; area of land helping to maintain belt of natural land between Tatsfield & Biggin Hill.
 - viii. Adj. Park Farm, Rag Hill Erection 2 det. houses with integral garages. 84/1116. No Action - permission for 2 houses already granted.
 - ix. 84/1137 Woodlands, Ricketts Hill. Ext. to provide add. living accommodation & erection of det. 4 car garage. J. Reilly, Woodlands No Action. Mr. Galiot, Pine View Ricketts Hill submitted copy of his letter to District Council objecting to erection of 4 car garage.
 - b. Crown Road (3 b) Nothing Further.
 - c. Footpaths & Stiles, Kemsley Woods (3 c) Further estimate for fencing awaited. Original estimate for fencing woodland reduced by £167 due to adjustment in length of fencing required. Agreed to proceed on most favourable estimate. Miss Creay, C. Engineer's Dept., reports stile on Footpath 19 to be satisfactory & stile on 21/21A appears reasonably easy to climb - any problems on this stile to be referred back. Surrey C.C. will contribute £171.81 towards cost of purchasing footpath signs and markers. (total cost £251.81)
 - d. Footpath Ninehams/Moesmeur Rds. (3 d) Nothing Further.
 - e. Connections Box Village Hall (3 f) This item to be deleted from Minutes, following Dr. South's enquiries.
 - f. New House by Franklyn Ricketts Hill (3 f) Erection of bollards. C. Engineer dealing with matter.

R.T.P.

Matters Arising (Cont'd)

- e. Land Between Scrumdoone/Anedral Greenway (4 h) Notice regarding possession of land published in Surrey Mirror.
- h. Abandoned Cars (4 i) District Council to be contacted for information on their findings concerning 2 cars reported as abandoned.
- i. Footpath 564 Crossways/Westmore Green (3 k) Miss Creay, C.Engineer's Dept., will endeavour to programme tarmacadam work on path in current year. District Council has cut back overgrown corner of Green near this path.
- j. Swings & Play Area Westmore Green (3 l) Cost of providing soft area beneath children's equipment approx. £5000. Enquiries to be made as to availability of any funds for such a project.
- k. Village Pond (3 m) Cause of leakage not yet located. Urgent need to carry out any necessary work as soon as practical.
- l. Commons Registration Act 1965 (3 n) Ownership of unclaimed land. Further statutory statement required by Commons Commissioner.
- m. Clacketts Lane Service Area (3 o) Nothing Further.
- n. Entertainments Licence Village Hall (3 p) Application to be heard on January 16th.
- o. Circus de Reszke (3 q) Dates confirmed - 2nd & 3rd April 1985.
- p. Path Through Bluebell Wood. Closure (3 r) Nothing Further.
- q. Manor Road (3 s) Bad state of road by Flowerdale. Owner carried out some remedial work to road.
- r. Countryside Estate Hill Park. Scrub Clearance (3 t) P.Council thanked by Surrey C.C. for constructive comments made regarding scrub clearance.
- s. Branzore Ship Hill. Stables (3 v) Environmental Officer visited site. Manure now removed from ditch.
- t. Bus Shelter. Vandalised (4) Nothing further on possibility of Youth Club carrying out repairs.
- u. Pilot Village Representative Scheme (5 d) Promoted by Surrey Voluntary Service Council. Mrs. McHugo already represents Tatsfield. RTP
- v. Potholes (8 a) Approach Rd. by Hedgrove, near The White House & by Village Hall. To be reported to Highways.
- w. Use of Agricultural Shed Kenscot, Kensley Rd. (8 b) Owner has agreed to cease storage & repair of vintage cars by end of Feb. '85 failing which, prosecution proceedings will be carried out.
- x. Precept Requirements for 1985/6 (7) Following discussion of Budget it was proposed by Mrs. McHugo & seconded by Dr. South and agreed unanimously that the Council should Precept for £3222 - Parish Rate of 1.5p.
4. Public 5 Minutes Mr. Hayes raised question of derelict cars (see 3h) plus Austin van in Maesmaur Rd.

RTP

5. Correspondence

- a. Countryside & Town Forum held on Dec.7th 1984
Summary of Proceedings - In circulation.
- b. Re-organisation of structure of Surrey Constabulary. Meeting
to be held at Reigate Police Station 22nd January 1985.
- c. Alleged Public Footpath between Lusted Hall Lane & Furze Corner
Surrey C.C. wish to know whether P.Council still feel this
should be included in Definitive Map.
Request was made in 1969.

6. Accounts For Payment

Clerk's Expenses Dec'84/Jan'85	8.67	Proposed by Mr.Payne Seconded by Mrs.Player
Clerk's Wages Jan'85	41.66	" "
Donation Oxted & District Social Centre	75.00	Proposed by Miss Garnham Seconded by Dr.South
St.Mary's Churchyard Fund	50.00	Proposed by Mrs.Player Seconded by Mrs.McHugo

Agreed to transfer £200 from Deposit to Current A/C.

7. Any Other Business

- a. But an Ben, Ricketts Hill. Demolition of original house has to
be carried out 3 months after occupation of new dwelling.
- b. Quantity of building material deposited at end of Old Lane.
Dr.South will approach owners of household responsible to
request its removal.
- c. Dr.South reported changes in footpaths 21/21A. Diversion made
at one point on 21. 21A opened up & stile erected.
2 large sheds erected in this area.District Council to be
asked whether planning permission required.
- d. Mrs.Player reported bad condition of Johns Road.
- e. Bridleway from Lusted Hall Lane to Beddlestead Lane
obstructed by barbed wire. London B.Bromley to be asked to
investigate.
- f. Segas to be asked to re-instate verge from Cobdale Ricketts Hill
to bottom of road - due to work being carried out at Mayfield.
Owner of Mayfield to be asked to remove chalk from bank
alongside Ricketts Hill.

The Meeting closed at 10.10 p.m.

R. J. Payne
11/2/85

TATSFIELD PARISH COUNCIL

Minutes of Meeting of Tatsfield Parish Council held at Tatsfield School on Monday, 11th February 1985 at 8 p.m.

Present Miss Garnham, Mrs. McHugo, Mr. Payne in the chair, Mrs. Player, Mr. Reeve, Dr. South, the Clerk and ten parishioners.

1. Apologies for Absence. Mr. Shaw's absence approved by Council.
2. Minutes of Meeting held on 14th January '85 were amended, confirmed & signed. Proposed by Dr. South & seconded by Mrs. McHugo.

3. Matters Arising.

a. Planning Applications

- i. Rose Cottage Westmore Green (3a i) Rubble on Green. Owner to restore Green on completion of building work.
- ii. Maybank Old Lane (3a iii) Houses to be built on bank with garages projecting forward of main building at road level.
- iii. Grounds of Hermes Paynesfield Rd. (3a iv) Erec. of det. dwelling Nothing Further.
- iv. Land at Kylemore Paynesfield Rd. (3a v) Erec. of det. dwelling Circular house with dome. Permission granted.
- v. Park Farm Rag Hill (3a vi) Erec. of farmhouse. Nothing Further
- vi. Land East of Manor House fronting Manor Rd. (3a vii) Erec. of det. house & garage. Permission refused.
- vii. 79/P/1843 Pine Lodge Maesmaur Rd. Extension. Amendment to plan already approved. No Action.
- viii. 85/P/0014. Rylands Ship Hill. Single storey side & rear ext. to provide utility room & living room. Objections: excessively large ext. for size of plot; un-neighbourly & crowded development
- ix. 85/P/0023 Woody End Johns Rd. Enlargement of garage & 1st floor add. to provide 2 beds, ensuite bathroom & store. No Action.
- x. 85/P/0045 Green Bushes Parkwood Rd. Retention of replacement garden building comprising changing/playroom, loose box & general store. Strong objections: Green Belt; Area Great Landscape Value, area where other exts. & buildings have been strictly controlled; building carried out before application made & has no building regulations imposed with mix of accommodation, stable & store.
- xi. 85/P/0028 Fairfield, Tatsfield Garage, Paynesfield Rd. Demolition of workshop & store & erec. of det. house with integral garage. No Action.
- xii. 85/P/0050 Jesalen Westmore Rd. Alteration to angle of roof & installation of 2 dormer extensions to provide room in roof. No Action.
- xiii. 85/P/0070 Construction of Leisure Centre, Manor Park, Whyteleafe. Chairman of Catecham Residents Assocn. seeks support in opposing application on grounds of high cost to ratepayers in District & loss of amenity at Manor Park. Parish Council decided to take No Action.

Mrs. McHugo will deal with planning applications during next month.

- b. Crown Road (3 b) Nothing Further. Clerk to check whether Mr. Watson visited solicitor in December.
- c. Footpaths & Stiles & Kennley Woods (3 c) Estimate for fencing accepted. Work to be carried out shortly.
- d. Nothing Further to report on following matters:-
Footpath Ninehams/Maesmaur Rds. (3 d) Footpath 564 Crossways/
Westmore Green (3 i) Clackette Lane Service Area (3 1)
Path through Bluebell Wood (3 a) Use of Agricultural Shed
Kenscot Kennley Rd. (3 u)

R.F.P.

Matters Arising (Cont'd)

- e. New House by Franklyn Ricketts Hill (3 f) C.Engineer to be reminded of road hazard caused by erection of bollards.
- f. Land Between Norwoodons/Anedral Greenway (3 g) It was resolved that 'Parish Council Land' markers be placed at corners of land by fencing contractors.
- g. Abandoned Cars (3 i) Reported that red mini in Messman^{rd.} is not abandoned. Shell of van removed.
- h. Swings & Play Area Westmore Green (3 j) Provision of soft area & extra equipment. Possibility of available funds being investigated.
- i. Village Pond (3 k) Various methods to locate cause of leakage discussed. Thames Water Board to be contacted also Surrey C.Council & District Council. Enquiries to be made to discover whether 'pond expert' available in County.
- j. Commons Registration Act 1965 (3 m) Ownership of unclaimed land, King Edward VII Memorial Garden - Further statutory statement in preparation. Ashen Shaw, Register Unit CL.379 Commons Commissioner's decision - land in question to remain subject to protection under Section 9 of Act of 1965.
- k. Entertainments Licence Village Hall (3 n) Intermediate Public Entertainment Licence granted until 31st October 1985.
- l. Circus de Reske (3 o) to visit Tatsfield 2nd & 3rd April.
- m. Manor Road (3 g) Bad state of road by Flowerdale. To be kept under surveillance.
- n. Countryside Estate Hill Park Scrub Clearance (3 r) Not yet carried out.
- o. Bus Shelter, Vandalised (3 t) No further progress on repairs
- p. Pilot Village Representative Scheme (3 u) Ascertained Mrs. McHugo is not the representative for this scheme. Mrs. Kathleen Wheeler has expressed an interest in project.
- q. Potholes (3 v) Some have been repaired. Mrs. Player to telephone District Council re pot-hole outside The White House.
- r. Alleged Footpath between Lusted Hall Lane/Furse Corner (5 e) No claims received re knowledge of use of track as Public Right of Way. London B.Bromley report their section of track not on Definitive Map and no claims received for inclusion.
- s. Put an Ben (7 a) Original house due for demolition 3 months after occupation of new dwelling.
- t. Quantity of Building Material deposited end of Old Lane (7 b) Owner of property, High Trees, will remove rubble in near future. Clerk to write confirming visit made by Dr. South.
- u. Changes in footpaths 21/21A & Erection of sheds (7 c) C.Engineer's Dept. aware of changes in path. Correct procedures now being carried out. Nothing further on erection of sheds.
- v. Johns Road (7 d) Bad condition reported by Mrs. Player.
- w. Eridleway Lusted Hall Lane (7 e) Obstruction. Now cleared.
- x. Signs .Damage to verge in Ricketts Hill & bank of chalk outside Mayfield Ricketts Hill (7 f) C.Engineer to be asked to deal with matter.

RJP

4. Public 5 Minutes Several residents complained of noise and nuisance caused by motor bike riding in field alongside Ricketts Hill/Paynesfield Rd. and asked for help and advice in stopping such use of field. Police have been called many times and Environmental Officer consulted by residents. Chairman will contact owner of land and District Council, also police to clarify legal position regarding use of these bikes. Residents were urged to attend Annual Parish Meeting to voice their feelings and write to M.P.

5. Correspondence

- a. Heathrow to be Doubled. Notice of Public Meeting 24th January '85.
- b. Review of County Boundaries. Parishes urged to consider possible change now.
- c. Consultative Draft. Surrey C.C. Public Transport Plan 1985/6. In Circulation.
- d. Surrey Best Kept Village Competition 1985 - agreed not to enter.
- e. Notice of Refund from Surrey C.C. of £142.50 for work on trench for sewer repairs (village hall/police house). Half this amount to be repaid to Surrey C.C. (different Dept.)
- f. Letter from Social Committee of St. Mary's Church requesting use of field behind village hall for barbecue & bonfire in summer. Agreed.

6. Reports

Village Hall Citizens Advice Bureau to commence Advice Sessions on March 14th in Committee Room.

Citizens Advice Bureau Agreed to donate £50 to C.A.B. with suggestion that some be spent on items to be useful for sessions in village hall.

Playing Fields Caravan Club visiting field 28 - 30 June.

7. Accounts For Payment

Clerk's Wages. February	41.66	Proposed by Mr. Payne, sec. by Miss Garnhan
" Expenses Jan/Feb	3.93	" " sec. by Mrs. McHugo
Surrey C.C. Use of school for Meetings Sent/Oct & Dec.	18.00	" " "
C.A.B. Donation	50.00	" " Miss Garnhan

Agreed to cancel donation of £75 proposed last month to Oxted & District Social Centre. Donation not due until June '85. Proposed by Miss Garnhan seconded by Dr. South.

8. Any Other Business

- a. April Meeting will be on 15th April due to Easter Monday falling on usual date.
- b. Due to Mr. Shaw's absence, enquiries to be made for election of Parish Councillor to take place on day of election for County Councillor.
- c. Date of Annual Parish Meeting Tuesday 30th April.
- d. Marjorie Horwood reports particular need for young offenders to be able to carry out community work. Suggestions made:- clearing woodland, planting hedge round new land behind village hall, emergency street plan, work on bridleways & eventually on the pond.
- e. Path alongside Ship Hill damaged in recent accident. Highways Dept. to be notified.

The Meeting closed at 11.10 p.m.

R. F. Payne
11/3/85.

TATSFIELD PARISH COUNCIL

Minutes of Meeting of Tatsfield Parish Council held on Monday 11th March '85 at 8 p.m. in Tatsfield School.

Present Miss Garnham, Mrs. McHugo, Mr. Payne in the chair, Mrs. Player, Mr. Reeve, Dr. South, the clerk & 4 parishioners.

1. Apologies for Absence received from Simon Dothie, District Councillor, due to the death of his father, Bill Dothie, Councillors expressed their sympathy with Simon on his loss.

Mr. Shaw's absence approved by Council - his offer of resignation discussed later. (3 v)

2. Minutes of Meeting held on 11th February confirmed & signed. Proposed by Mrs. Player, seconded by Mrs. McHugo.

3. Matters Arising

a. Planning Applications

- i. Rose Cott, Westmore Green (3a i) Rubble on Green. Owner apologised for inconvenience & will restore Green when work completed & queried whether plot of land in front of cottage could be purchased. Not possible - land constitutes part of Westmore Green given to Tatsfield Village.
- ii. Maybank, Old Lane (3a ii) Erection of 3 houses. Contractor to be asked to clear rubble & concrete from ditch opposite building work.
- iii. Grounds of Hermes, Paynesfield Rd. (3a iii) Erection of det. dwelling. Additional plans. Clearance of trees - strong objection made.
- iv. Park Farm, Rag Hill (3a v) Erection of farmhouse. Nothing Further
- v. Rylands, Ship Hill (3a viii) Side & rear extens. Permission granted.
- vi. Green Bushes, Parkwood Rd. (3a xi) Retention of replacement garden building. Permission granted.
- vii. 85/P/0102 Outline. Erection of car port & 1st floor ext. to provide 2 add. beds. The Laurels, Hillside Rd. No Action.
- viii. 85/P/0123. 1 Redhouse Rd. 2 storey side & rear extn. to provide garage & hall with 2 beds. over & raising height of pitched roof over existing kitchen. No Action.
- ix. 85/P/0171. Working Mens Club, Westmore Green. Construction of cellar for use as beer store & provision of new committee room on mezzanine floor. No Action.
- x. 85/P/0187 Erection of 3 det. houses & garages. Outline. West of Castleneau, fronting Old Lane. Objections: M.G.B. & defined in Surrey Structure Plan; no other building that side of Old Lane; area forms important part of open land stretching through to Biggin Hill; if allowed would set dangerous precedent leading to eventual built up area joining Tatsfield to G. London Area.

Mr. Reeve will deal with planning applications during coming month.

- b. Crown Road (3 b) Mr. Watson attended solicitor in Dec. Papers being prepared by solicitor to ask District Council to undertake litigation.
- c. Footpaths & Stiles & Kemsley Woods (3 c) Fencing work carried out round Parish woodland & land behind village hall. Footpath & boundary markers erected at Kemsley Woods & Ashen Shaw
- d. Nothing further to report on foll. matters: (3 d) Footpath Ninehams/ Maesmaur Rds.; Footpath 564 Crossways/Westmore Green; Path through Bluebell Wood; Use of Agricultural shed Kemsley Rd.

R.F.P.

Matters Arising (Cont'd)

- e. Clacketts Lane Service Area (3 d) Planning application not expected until summer.
- f. New House by Franklyn, Ricketts Hill (3 e) Erection of bollards.
C. Engineer unable to secure removal - not erected on highway land.
D. Councillor to be asked to take matter up with D. Council.
- g. Land Between Scrumdoone/Anhedral Greenway (3 f) Issuance of Land. (3 f)
'Parish Council Land' markers placed at four corners of land to mark boundaries.
- h. Swings & Play Area Westmore Green (3 h) Provision of soft area & extra equipment. Unable to ascertain whether any grants available towards cost other than through District Council for 'Voluntary & Recreational Organisations'. To be borne in mind as long term possibility.
- i. Village Pond (3 i) Loss of Water. Mr. Frank Watson reported on efforts made to discover reason of leakage. Representative from Brit. Trust of Nature Conservation Volunteers to visit Tatsfield on 14th March to offer advice.
- j. Commons Registration Act 1965 (3 j) Ownership of unclaimed land. King Ed. VII Mem. Garden. Commons Commissioner satisfied that Parish Council is also owner of small unowned area of this land and will direct S.C.C. to register Parish Council as the owner under Section 8 (2) of the Act of 1965.
- k. Circus de Reazke (3 l) To visit Tatsfield 2nd & 3rd of April.
- l. Manor Rd. (3 m) Bad state of road by Flowerdale. Owner apologetic at state of road caused by building work & promised to clear soon. Public Health Dept. to be notified about pile of manure at Sindolar Riding Stables - polluted water draining down road.
- m. Bus Shelter Vandalised (3 o) Youth Club will repair during lighter evenings.
- n. Pilot Village Representative Scheme (3 p) No further progress made since Mrs. K. Wheeler expressed interest in project.
- o. Potholes (3 q) Repairs are to be effected shortly.
- p. Alleged Footpath Between Lusted Hall Lane/Furze Corner (3 r) Path appears to have been private track from information received. Surrey C.C. to be informed.
- q. But an Ben, Ricketts Hill (3 s) Demolition of original house to be carried out 3 mths after occupation of new dwelling.
- r. Quantity of Building Material deposited end of Old Lane (3 t) Nothing Further.
- s. Changes in Footpaths 21/21A & Erection of sheds (3 u) Diversion of paths: can see good reason for diversion of 21A (C G) but object to diversion F to C which is long established & much used path between village & church. Object to path being diverted before public had chance to voice an opinion. District Council have been asked further about sheds.
- t. Segas (3 x) Damage to verges in Ricketts Hill & bank of chalk outside Mayfield. To be re-instated in next few days.
- u. Motor Bike Riding (4) Field alongside Ricketts Hill/Paynesfield Rd. Noise & nuisance caused to residents. Police Sergeant attended meeting of residents concerned to advise on legal situation. Owner of field verbally agreed to appear in court for any prosecution & to allow residents to act as agents including repair of fencing. Written agreement being sought.

→ permission to divert had been sought or

R.F.P.

Matters Arising (Cont'd)

- v. Election of Parish Councillor (8 h) Law does not allow for election of C.Councillor & Parish Councillor to be taken together. Mr. Shaw's resignation to be accepted and vacancy advertised.
- w. Ship Hill Footpath (8e) Repairs to damage caused to be carried out
4. Public 5 Minutes Mrs. Geary reported damage to Parish Noticeboard. Youths concerned detained by police. Mr. Tapsell repairing damage - estimate of £25 furnished to police.
Mrs. Geary presented Parish Council with a written report on the history of King Edward VII Memorial Garden.

Annual Parish Meeting (8 c) 30th April. Copies of March P. Council Minutes to be available for parishioners plus Minutes of last Annual Parish Meeting. Items for discussion: ? higher rate to pay for local issues; appeal to tidy village; replacement seat in memory of Ann Roper. Display suggested showing land owned by Parish. Agreed to change format of meeting by asking organisations if they require brief statement to be read out in order to give more time for general discussion.

5. Correspondence

- a. Surrey Voluntary Service Council. 'Youth Matters 1985'. Seminar to mark International Youth Year. University of Surrey Sat. 27th April.
- b. Tatsfield Horticultural Society. Permission sought to use Green for Plant Sale, 18th May 11-12 noon. Agreed.
- c. Mr. R.H. Drake selected as prospective Conservative candidate for Warlingham Division of S.C.C. Would be pleased to hear any views on S.C.C. policy affecting Tatsfield.
- d. Annual Meeting of Local Govt. Electors of Chelsham & Farleigh Parishes 15th April. Chairman & Clerk invited to attend.
- e. Survey of Rural Services 1985. Questionnaire to be completed.
- f. Oxted & District Work Centre. Buffet Supper to be held on April 19th in place of Annual General Knowledge Quiz. 2 members of Council invited
- g. Invitation for P. Councillor to attend Buckingham Palace Garden Party. Agreed this should be Mr. Payne, the Chairman.
- h. Mr. Tapsell offers to carry out maintenance to Notice Board. Offer gratefully accepted.

6. Reports. Village Hall Decrease in number of bookings.
Tarmacadam work to frontage urgently needed.

Citizens Advice Bureau. At recent meeting, Mrs. Horwood, Local Organiser, congratulated on starting advice sessions in village.
Mrs. Horwood thanked P. Council for donation, some of which was spent on advertising sessions to be held in village hall.

7. Accounts For Payment

Public Works Loan Board	400.31	Proposed by Mr. Payne	sec. by Mr. Reeve
Architect's Dept. S.C.C.	71.25	"	"
Clerk's Admin. Expenses	14.13	"	"
" Wages	41.66	"	Mrs. Flayer " Dr. South
Solicitor's Fee (King Ed. Grd.)	3.75	"	"

Agreed to transfer £200 from Deposit to Current A/C.

8. Any Other Business

- a. Informal Meeting of Representatives of P. Councils in Tandridge Area at Bletchingly 17th April.
- b. Fun Run. March 31st in aid of Action Research.
- c. Damage to Westmore Green by slip road to 'The End' caused by furniture van. Details given to District Council.

The Meeting closed at 11.45 p.m.

R.F. Payne
15/4/85.

TATSFIELD PARISH COUNCIL

Minutes of Meeting of Tatsfield Parish Council held on Monday
15th April 1995 at 8 p.m. in Tatsfield School.

Present Miss Garnham, Mrs. McHugo, Mr. Payne in the chair, Mrs. Player,
the clerk, and 6 parishioners.

1. Apologies For Absence received from Mr. Reeve, Dr. South & Mr. Dothie.
2. Minutes of Meeting held on 11th March were amended, confirmed & signed.
Proposed by Mrs. Player & seconded by Miss Garnham.

3. Matters Arising

a. Planning Applications

- i. Rose Cott, Westmore Green (3a i) Rubble on Green
Owner will restore Green on completion of building work.
- ii. Maybank, Old Lane (3a ii) Erection of 3 houses, Rubble in ditch.
Mr. Picard had cleared ditch opposite building works.
- iii. Grounds of Hermes, Paynesfield Rd. (3a iii) Erection of det.
dwelling. Permission refused.
- iv. Park Farm Rag Hill. (3a iv) Erection of farmhouse.
Permission refused.
- v. Erection of 3 det. houses & garages. Outline, Castlensew,
fronting Old Lane (3a x) Permission refused.

Mr. Reeve will be asked to deal with planning applications again this month

b. Crown Road (3 b) Nothing Further.

c. Footpaths/Kemsley Woods/Fencing

- i. Account received for fencing woods, land behind village hall -
cost partly shared with Mr. Reeve whose land adjoins P. Council
land - & erection of footpath markers & Parish Council Land
markers. Total £1031.23 excluding part for which Mr. Reeve
is responsible. (7 o)
- ii. Footpath Ninehams/Maesmaur Rds. Footpath 564 Crossways/
Westmore Green and Path through Blueball Wood. (3 d)
Nothing Further.
- iii. Alleged Footpath between Lusted Hall Lane/Furze Corner, S.C.C.
informed this had been private track. (3 p)
- iv. Changes in Footpaths 21/21A. Further letter to be sent
expressing objections over diversion.
- d. Nothing Further to report on: Use of Agricultural Shed, Kemscoot
Kemsley Rd. (3 d) District Council to be contacted again on:
But an Ben, Ricketts Hill, demolition of original house (3 Q) and
Erection of Sheds - field 5547 near footpath 21/21A (3 s)
- e. Clacketts Lane Service Area (3 e) Nothing Further.
- f. New House by Franklyn, Ricketts Hill (3 e) Erection of bollards.
District Councillor to be contacted on this, also
builder if possible.
- g. Land Between Scrumpoons/Anhedral, Greenway (3 g) Possession of
Land. Nothing Further to report.
- h. Swings & Play Area Westmore Green (3 h) Future provision of soft
area and extra equipment to be borne in mind.
- i. Village Pond (3 i) Loss of Water. Mr. Frank Watson reported work on
pond to commence 22nd April to dig out bentonite & debris &
prepare to put down clay lining on 26th & 27th April with help
of volunteers including Scouts. Clay being provided free by
Redland Tiles & letter of thanks to be sent to Mr. Hanscombe.
Provision of Insurance cover for helpers to be investigated,
also possibilities of obtaining Grants for project.
Proposed by Mrs. McHugo & seconded by Mrs. Player & agreed
unanimously, that up to £700 be available from Parish Council to
cover cost of hiring mechanical digger, removal of bentonite &
other debris from pond, hire of pump, haulage of clay & insurance

R. T. Payne

Matters Arising (Cont'd)

- j. Commons Registration Act 1965 (3 j) Ownership of unclaimed land. King Edward VII Memorial Ground. Solicitor's costs for dealing with this matter £60 + £9 VAT.
- k. Circus de Rosska (3 k) No apparent problems caused. £25 received for rent of Green.
- l. Manor Road (3 l) State of Road. Verge opposite Flowerdale has been restored. District Council report liquid from manure heap outside Sindolar Riding Stables does not appear to affect water courses. Owner will eventually cover heap with soil.
- m. Bus Shelter Vandalised. (3 m) Youth Club will repair.
- n. Pilot Village Representative Scheme (3 n) Mrs. Wheeler has agreed to represent Tatsfield.
- o. Potholes (3 o) Repairs carried out. Machinery caused damage to Green by Bus Shelter.
- p. Quantity of Building Material End of Old Lane (3 p) District Council to be asked to secure removal of rubble & investigate rain water pipe draining on to Lane.
- q. Segas (3 t) Damage to verges in Ricketts Hill & bank of chalk outside Mayfield. Verges not yet reinstated. Reminder to Area Engineer.
- r. Motor Bike Riding (3 u) Field alongside Ricketts Hill/Paynesfield Rd Noise & Nuisance caused to residents. Fencing of gaps & new stile to field under consideration. Noise has abated recently.
- s. Election of Parish Councillor (3 v) Vacancy advertised for statutory period. No Notice to hold an election was received by District Council and vacancy has to be filled by co-option.
- t. Parish Notice Board (4) Vandalised. Mr. Tapsell has carried out repairs and his offer for maintenance work on Board gratefully accepted. Parish Council to pay for materials.
- u. Oxted & District Work Centre Buffet Supper. (5 f) Mrs. Player to attend.
- v. Informal Meeting of Reps. of Parish Councils in Tandridge Area (8 a) 17th April. Mrs. McHugo hopes to attend.
- 4w. Damage to Westmore Green (8 c) Caused by furniture van. Repairs to be carried out.

Annual Parish Meeting 30th April. Village Hall 8 p.m.

Coffee & Biscuits to be served at 8 p.m. followed by Reports & General Discussion. Items for discussion include: Local Parish Rate; Possible future changes in County Boundary; Pride in your village - litter problems; replacement seat in memory of Ann Roper.

4. Public 5 Minutes

- a. Mrs. Geary asked for clarification on wedge of land recently established to be owned by Parish Council (King Edward Mem. Grd. 3j)
- b. Mr. Watson confirmed track from Furze Corner to Lusted Hall Lane had been private path.
- c. Mrs. Bradshaw has panelling from bus shelter ready in Hall for repairs.
- d. Mr. Barnes voiced strong feelings over felling of trees at Waylands Approach Rd. (Matter previously in Minutes 10 Dec. 3u). This matter was discussed fully and District Council will be informed of Parish Council's grave concern over loss of trees.

RT Payne

5. Correspondence

- a. Request to hold sponsored litter collection in Tatsfield by Miss Stavers of Oxted, in aid of Battersea Dogs Home. Agreed. Council to offer help as needed.
- b. Public Works Loan Board-Late Payments- Interest to be charged on whole of Late Payments in future. Direct debiting facility to be offered 1985/6. Agreed that payment by cheques allows Council to control payments more reliably.
- c. Surrey Constabulary. 'Presentation Evening' to meet senior officers at Reigate Police Station 16th April 7.45 p.m.
- d. Notice of Audit. 24th June 1985.
- e. Joint Twinning Committee of Local Authority Assocns. calls for all local authorities to support & encourage twinning programmes.
- f. Mrs. Flowers, Oakdene, Old Lane, Copy of letter sent to District Council by Mrs. Flowers on objection to proposed development at Castlemeau.
- g. Tatsfield School. ^{participating in} Doomsday Survey to be carried out by B.R.C. Pupil writes for some information to be given by Council.

6. Reports Playing Fields Association.

- i. Success achieved in getting zero rating on pavilion etc.
- ii. Request for grant towards cost of laying new drainage system to temporary changing rooms - £170. Proposed by Mrs. Flayer & sec. by Mrs. McHugo that £70 be donated in due course. Agreed.

Village Hall

Draft financial statement presented. Not adopted by Council as Bank Statements not to hand when prepared.

7. Accounts For Payment

Wheeler John & Son.Solicitor.	69.00	Proposed by Mr.Payne, sec. by Mrs. Flayer
Preparation of Statutory Declaration, King Ed. Mem. Grid.		
Surrey C.A. of P.&T. Councils	72.45	" "
Annual Sub. Review, & Forms		
Payment for Work on Fencing Messrs. Pinnington Bros.	1031.23	" "
Clerk's Expenses March/April	14.47	" sec. Mrs. McHugo
" Wages April	41.66	" " Miss Garnham

It was agreed to transfer £1800 from Deposit to Current A/C.

8. Any Other Business

- a. Hydon Homes to be asked to reinstate Green damaged by tractor & query whether provision of path was not on their plans from entrance to existing path on Green.
- b. Green churned up outside garden fence of new house end of Grove Rd. District Council to be asked to approach owners to reinstate Green
- c. Footpath 17 reported to be overgrown - some doubts expressed by Councillors on this.

The Meeting closed at 11.30 p.m.

R. F. Payne
13/5/85

1

TATSFIELD PARISH COUNCIL

Minutes of Annual Meeting of Tatsfield Parish Council held on Monday,
13th May '85 at 8 p.m. in Tatsfield School.

Present Mrs. McHugo, Mr. Payne, Mrs. Player, Mr. Reeve, Dr. South, Mr. Dothie
District Councillor, the Clerk and 10 parishioners.

1. Apologies for Absence received from Miss Garnham.
2. Election of Chairman. It was proposed by Mrs. McHugo & sec. by Mrs. Player that Mr. Payne should continue as Chairman. No further nominations were made and Mr. Payne took the chair.
3. Election of Vice-Chairman On the proposition of Mrs. McHugo & sec. by Mrs. Player, Dr. South was elected Vice-Chairman.
4. Co-Option of Parish Councillor. It was proposed by Mr. Payne & sec. by Dr. South that Mr. Ian Mitchell should be co-opted to fill the vacancy of Parish Councillor. Mr. Mitchell accepted the proposal and joined the Council.
5. Appointment of Representatives as follows:

S.C.A. of P. & T. Councils. & School Governors	- Mr. Reeve
Village Hall - Mrs. McHugo & Dr. South.	C.A.B. - Mrs. Player
Youth Club - Dr. South & Mrs. Player.	C.A.T.S.A. - Mrs. McHugo
Village Pond - Mr. Mitchell.	Bridleways Assocn. - Miss Garnham
Vern D'Anjou - to be discussed at next meeting.	
6. Minutes of Meeting held on 15th April confirmed & signed.
Proposed by Mrs. Player & sec. by Mrs. McHugo.
7. Matters Arising
 - a. Planning Applications
 - i. Rose Cott. Westmore Green (3a i) Rubble on Green - to be cleared on completion of building works.
 - ii. 85/P/0311 The Briars, Ninehams Rd. Demolish existing garage & erect double garage. No Action.
 - iii. 85/P/0335 9 Paynesfield Rd. Demolish part of bungalow & extend to form dining room on ground floor with 3 beds. shower room & study/playroom as new 1st floor. No Action.
 - iv. 85/P/0342 St. Elmo Maesmaur Rd. Demolish existing & erect new bungalow. J.M.C. Contracts Croydon Ltd. No Action.
 - v. Appeal. Land east of Manor House fronting Manor Rd. Erect det. house. Our objections submitted to Dept. of Environment.
Mrs. Player to deal with planning applications for coming month.
 - b. Crown Road (3 b) Solicitor has asked C. Engineer to take steps to deal with our request to restore northern end of road as a Public Highway. Solicitor's interim note of charges - £258.75
 - c. Footpaths (3 c)
Nothing Further on:
 - i. Footpath Ninehams/Maesmaur Rds.
Footpath 564 Crossways/Westmore Green.
Path Through Bluebell Wood.
 - ii. Changes in footpaths 21/21A. Nothing Further.
C. Engineer to be contacted.
 - d. Properties in Tatsfield (3 d) Use of Agricultural Shed, Kemscoot, Kemsley Rd. -- Repair of vintage cars has ceased.
Demolition of But an Ben, Ricketts Hill - to be commenced shortly
Erection of sheds, field off Church Lane - buildings being used in connection with agricultural enterprise & planning permission not required.

RTP

Matters Arising (Cont'd)

- e. Clacketts Lane Service Area (3 e) Awaiting planning application
- f. New House by Franklyn Ricketts Hill (3 f) Erection of bollards
District Councillor questioning both District & County Councils
on claim that bollards are not on highway land.
- g. Land Between Scrundoone/Anhedral Greenway (3 g) Possession of Land
More clearance of nettles etc. to be carried out on June 12th.
- h. Village Pond (3 i) Pond has been dug out & clay lining put down &
refilled with water. Everyone who helped was thanked for their
hard work. Soil and turves have been purchased to restore
Green and edges of pond.
It was agreed that hire of JCB, haulage of clay & clearance of
pond - £897 should be paid by P.Council.
Proposal made by Mrs. McHugo & sec. by Dr. South.
The Pond Assocn. will make donation of £200 to Parish Council
less sundry expenses paid by Mr. Frank Watson.

Mrs. Geary was presented with the plaque made by Mrs. Evelyn Cooke
(Minutes 14th March 1983, 2 j), to commemorate her being granted
commoner's Rights to keep ducks on village pond.
Plaque will be fixed to wall of her cottage.
- i. Bus Shelter. Vandalism (3 m) Mrs. Player will remind Mr. Jackson
about Youth Club carrying out repairs.
- j. Potholes & Damage to Green & Verges (3o & 3q) Highways to be
notified of general erosion to edges of Westmore Green &
reminded that verges damaged in Ricketts Hill by Sagas have
not yet been repaired.
- k. Motor Bike Riding (3 r) Field alongside Ricketts Hill/
Paynesfield Rds. Bike riding has ceased and following
pressure by residents, local authorities & police about noise
& nuisance caused, owner has asked riding stables to use
field. Some fencing of gaps has been carried out.
- l. Parish Notice Board (3 r) Vandalism. Mr. Tapsell to be paid £25
for carrying out repairs following vandalism & it will be
ascertained whether maintenance agreed to has been carried out
- m. Informal Meeting of Representatives of P.Councils in Tandridge
Area (8 a) April 18th. Mrs. McHugo attended. Main topics:
mineral workings, sewage, waste disposal. Next Meeting
23rd October at Burstow.
- n. Annual Parish Meeting 30th April. New format deemed to be an
improvement - coffee first followed by brief reports from
associations read from chair. Problem of litter discussed &
will be further investigated. Frequency of street cleaning
to be ascertained & draft letter prepared to circularise
all households re litter.
- o. Waylands Approach Rd. Felling of Trees (4 d) Approval given by
District Council for schedule of surgery & felling of 34 trees
Proceedings in hand for unauthorised surgery to 7 preserved
oak trees & felling of 1 preserved holly.
- p. Sponsored Litter Collection (5 a) June 23rd. Further details
of sponsorship & help required will be ascertained.
- q. Rydon Homes (8 a) Re-instatement of Green and question of
pathway. No reply received.
- r. Westmore Green End of Grove Rd. (8 b) Damage to Green rear of
new house. Mrs. Player will watch situation.

R.P.P.

8. Public 5 Mins.

- a. Mrs. Bradshaw. Reported 'No Through Rd.' sign in Paynesfield Rd. has disappeared.
Requested that future consideration be given to providing tennis courts on land behind village hall.
- b. Mrs. Hayes stated that Bridleways were not in conflict with footpa the and in fact are often looked after by Bridleways Assocn.
- c. Mrs. Hallett voiced strong opinions against unsightly town houses built at Maybank Old Lane. It was agreed to inform District Council that it was felt a lack of consideration was given to our views over planning matters. A representative from the planning dept. will be invited to attend a Parish Council meeting in the Autumn.

9. Correspondence

- a. Update of Definitive Rights of Way Map & Statement rec'd.- In circulation
- b. Audited Accounts & Annual Report. Oxted & District Social Centre - In circulation. Grant to be considered at next meeting.
- c. Copy of letter sent by District Council to Mr. Savery, Tatsfield concerning 'Land at Lusted Hall Lane'. Survey of Land owned by District C.
- d. Thames Water. Consumer Consultative Committees.-letter in circulation
- e. Application form for hire of school premises Sept '85/July '86. Agreed to hold P. Council Meetings at school for this period.
- f. Notes of Meeting of Police Liason Group 4th March. - In circulation.
- g. Permission sought by Mr. McHugo to use Green 8th Sept. to celebrate officia. covenanting of churches. Agreed.
- h. Permission sought by Scout Group to use Green 29th June. Annual Fete. Agreed
- i. C.A.B. Request for Council to finance sessions for further three months. Agreed.

10. Reports C.A.B. Very successful A.G.M. held recently.

Village Hall Financial Statement 84/5 adopted. Prop. Mrs. Player sec. Dr. South

11. Accounts For Payment

Reeves-Eastwood hire of JCB(Pond) 230.00 Prop. Mrs. McHugo sec. Mrs. Player
 McKenna Demolition Ltd. Haulage of clay 567.00 " " " "
 S.C.C. Hire of school 30.00 Insurance(Pond) 10.00 } -prop. Mr. Reeve. sec. "
 Open Spaces Annual Sub. 7.00 }
 Insurance Village Hall 164.07 Clerk's Wages May 41.66 } Prop. Mr. Payne
 Clerk's Expenses April/May 6.67 } -sec. Mrs. McHugo
 Mr. Tapsell. Repairs to Notice Board 25.00 Prop. Mr. Payne sec. Mr. Reeve

It was proposed by Mr. Payne & sec. by Mr. Reeve that the Clerk's wages should be increased from £500 to £600 p/a as from 1st April 1985.

It was agreed to precept for £1500.

12. Any Other Business

- a. Dr. South drew attention to fact that no post had been delivered to Tatsfield ^{two} ~~on days of heavy snow~~ ^{heavy snow} ~~fall~~ due to lack of knowledge of area by staff. *RHP*
- b. Karen Heffernon is running both Brownie & Guide Packs & letter of thanks will be sent and support offered.
- c. Dr. South pointed out that planning permission for house in Shaw Rd. with 2 storage rooms upstairs was now advertised as 4 bedroom house.
- d. Mrs. Player concerned that no screening trees had been planted at 'Smokey Mountain' Approach Rd. & will contact London B. Bromley.
- e. Village Policeman no longer lives in Tatsfield. Position to be clarified with Police Authority.
- f. Byelaws for Greens will be looked into with view to any possible changes and procedure involved.
- g. This being 'Year of the Youth'. Has P. Council any proposals for action?
- h. Trench dug by Seaboard across Green. Needs rolling & attention by 'The End'
- i. Permission sought to have 3 stalls on Green May 18th in aid of village Play Groups. Also sponsored 'Toddle' May 22nd. Agreed.

The Meeting closed at 11.45 p.m.

R. J. Payne
10/6/85

TATSFIELD PARISH COUNCIL

Minutes of Meeting of Tatsfield Parish Council held on Monday 10th June 1985
at 8 p.m. in Tatsfield School.

Present: Miss Garnham, Mrs. McHugh, Mr. Mitchell, Mr. Payne-in the chair,
Mrs. Pleyer, Mr. Reeve, Dr. South, Mr. Dohie District Councillor, the
clerk and six parishioners.

1. Minutes of Annual Meeting held on 13th May were amended, then confirmed and signed. Proposed by Mr. Mitchell & seconded by Dr. South.

2. Matters Arising

- a. Planning Applications

- i. Rose Cott, Westmore Green (7a i) Very little rubble now on Green
 - ii. Appeal. Land east of Manor House (7a v) No decision yet.
 - iii. 85/P/8403 The Laurels, Hillside Rd. Single storey side extension to provide bedroom & shower room/WC. No Action.
 - iv. 85/P/0411 18 Lusted Hall Lane. 2 storey rear extn. to provide new kitchen with 2 adl. beds. over. Objection: could be detrimental to amenities of neighbouring properties. Single storey would appear to be more acceptable. Permission refused.
 - v. 85/P/0447 Ship Hill House, Ship Hill. Change of use to provide 2 semi det. dwellings. No Action.
 - vi. 85/P/0450 Joyfields, Chestnut Ave. Erection of conservatory on side elevation. No Action.
 - vii. Appeal. Porziuncular, Parkwood Rd. Erection of new double gate attached to front of original. Our objections sent to Sec. of State
Mrs. McHugh will deal with planning applications for coming month.
- b. Crown Road (7 b) Case should have been referred to Legal Dept. under Highways Act & not Public Rights of Way. Mr. Payne to phone solicitor
- c. Footpaths (7 c) Nothing further on:
 - i. Footpath Minehams/Maesmaur Rds. Footpath 564 Crossways/Westmore Green. Path Through Bluebell Wood.
 - ii. Changes on footpath 21/21A. Nothing further to report until committee meets after summer recess. Adjoining owner will be submitting application. C. Engineer to be asked when diversion will be publicised.
- d. Demolition of But an Ben, Ricketts Hill (7 d) District Council to be asked when this will commence.
- e. Clacketts Lane Service Area (7 e) Planning Application not yet submitted.
- f. New House by Franklyn, Ricketts Hill (7 f) Erection of bollards. Enquiries being carried out by District Councillor.
- g. Land Between Scrumdons/Anhedra, Greenway (7 g) Possession of Land Further clearance of land on June 12th.
- h. Village Pond (7 h) £74.56 rec'd from Pond Assocn. - bal. of £200 donation to P. Council towards pond restoration less £125.44 expenses incurred (Pipe & Coupling 8.61, Sludge Pump 13.74, Plate Compactor 22.59, turf & soil 80.50).
- i. Bus Shelter, Vandalism (7 i) Mr. Jackson will obtain materials, solid boarding, & Dr. South will help youth club members carry out repairs
- j. Damage to Green & Verges (7 j) Inspection carried out by C. Engineer's Dept. Verges in Ricketts Hill not yet restored.

R.P.P.

Matters Arising (Cont'd)

- k. Parish Notices Board (7 l) Vandalism. Mr. Tapsell would not accept £25 from P. Council for repairs following vandalism. Mr. Tapsell to be thanked & asked to claim 'out of pocket' expenses.
- l. Litter & Street Cleaning (7n & 7 p)
Dr. South & Mr. Mitchell have produced letter for circulation to all households concerning litter and giving information on land owned by Parish.
Sponsored litter collection by Miss Stevens on June 23rd.
Street cleansing - small increase in resources available should produce some improvement in village.
- m. Rydon Homes (7 q) Damage to Westmore Green. Mr. Payne will contact Rydon Homes. District Council to be asked whether a through route from Green to Westmore Rd. for pedestrians, was shown on plans. Residents of estate asked whether signs stating 'Private Estate' could be erected. Agreed small signs would be in order. Problems over use of access from Green were discussed.
- n. Westmore & Tatsfield Greens (7 r) District Council will inspect & carry out any necessary works adjacent to Grove Rd. District Council will be asked to ensure entire Green is mown - near Rose Cott. and round trees, also whether arrangements have been made for cutting Tatsfield Green. Complaints made of tall vegetation left alongside Ricketts Hill Greens.
- o. 'No Through Road' sign, Paynesfield Rd. (8a i) Not yet replaced.
- p. Meetings with Planning Officer (8 c) To be arranged.
- q. Oxted & District Social Centre. Grant (9 b) Proposed by Mrs. McHugo & seconded by Mr. Mitchell to donate £90. Amendment proposed by Mr. Reeve & sec. by Dr. South to keep figure at £75. 4 voted in favour of amendment & 3 against. Sum of £75 will therefore be donated.
- r. Screening Trees Smokey Mountain, Approach Rd. (12 d) London B. Bromley to be contacted re planting of trees.
- s. Village Constable (12 e) Meeting to discuss matter will be held after July 8th.
- t. Seaboard. Levelling of trench across Green (12 i) To be pointed out that heavy machinery should not be used near 'The End'. Wayleave Consent in preparation, various restrictions not accepted.
3. Public 5 Minutes Items raised: a. Can footpath 21/21A be walked on established route - Yes, provided fences/hedges not damaged.
b) Woods Estate - reports of mail being wrongly delivered.
c) Clarification to be sought from Post Office re numbering of 'Bargeboards' Westmore Rd. as No 1, lying between Nos 38 & 40.
d) Barbed wire fence erected alongside section of Tatsfield Lane - Westerham Hill end - potential hazard, Sevenoaks D. Council to be contacted.
● Alleged Public footpath between L.H. Lane & Furze Copse (Miss 30.11.85) Some residents now state knowledge of path being used. Evidence forms needed. R.T.P.
4. Correspondence
- a. Letter sent to Mayor of Vern d'Anjou expressing wish for continued friendship between Tatsfield & Vern.
- b. Letter to Mr. Shoulder, The Beeches, Old Lane, re motorised tricycle riding in Tatsfield Green woods.
- c. Playing Fields Assocn. Query - when can grant of £70 be paid. Agreed to pay this month.
- d. Surrey Family Practitioner Committee. Press Release. In circulation.
- e. Rights of Way. Alleged Public Bridleway leading from Kensley Rd. to Ricketts Hill via Paynesfield Rd. C. Engineer to be informed this was always regarded as road open to all traffic.
Alleged Bridleway. Clarks Lane/Chestnut Ave. Miss Garnham to investigate.

R.T.P.

5. Reports

Tough Club A.C.H. held, Finance sound. 100 members, 25/30 attend meetings. Junior helper & treasurer required, plus more adult help. Watford Emergency Numbering Plan - Mr. Jackson not had time to finish project, Mr. South will approach someone who may be able to take over.

Village Hall. Fire Prevention Officer will be giving advice on fire precautions. Booking Secretary would be pleased to resign & Mrs. Pennington may be prepared to take over. Agreed to copy 1984/4 VAI next meeting.

Quote will be obtained to supply & erect 2 gates, 1 each corner leading into land behind hall.

Vern division New committee elected - Chairman Mr. Brian Nash, secretary Mrs. Karen Nash, treasurer Mr. Pinder. Mrs. Crofts (former treasurer) to be sent letter authorising her to relinquish funds to new treasurer.

Village Pond Holding water. District Council have cleared pipe from ditch. Duck house is being repaired.

Surrey C. Asscn. of R. & T. Councils. Meeting on 21st June.

6. Accounts For Payment

Playing Fields Asscn. Grant	70.00	Prop. by Mrs. McHale;	sec. Mrs. Player
Exted & District Social Centre Grant	75.00	"	Mr. Reeve " Dr. South
Hire of Village Hall C.A.B. sessions Mar/Apr/May	22.00	"	" " " Mr. Payne
P. Council Insurance	20.00	"	" " " "
Clerk's Expenses May/June	12.60	"	Mr. Payne " Mrs. Player
Clerk's Wages June + 15.84 increase for April & May	66.68	"	" " " "

Agreed to transfer £200 from Deposit to Current A/C

7. Any Other Business

Complaints made over smell in village caused by untreated sewage spread on some farmland.

Mrs. Player gave her apologies for absence from next meeting.

The Meeting closed at 11.55 p.m.

R. F. Payne
8th July 1985

Minutes of Meeting of Tatsfield Parish Council held on Monday 8th July 1985 at 8 p.m. at Tatsfield School.

Present Miss Garnhan, Mrs. McHugo, Mr. Mitchell, Mr. Payne - in the chair -, Mr. Reeve, Dr. South, the clerk and 29 parishioners.

The Chairman announced the sudden death of Mr. Godfrey Scheele, Chairman of Linpsfield Parish Council. Formal letter of sympathy will be sent to his widow.

1. Apologies for Absence received from Mrs. Player.

2. Minutes of Meeting held on 10th June were amended and signed. Proposed by Dr. South and seconded by Mr. Reeve.

3. Matters Arising

a. Planning Applications

- i. Rose Cott, Westmore Green (2a i) Rubble on Green. Nothing further to report.
- ii. Appeal. Land East of Manor House (2a ii) Nothing Further.
- iii. Appeal. Porziuncular, Parkwood Rd. (2a vii) Erection of double garage att. to front of original. Nothing Further.
- iv. 85/P/0513. Grounds of Hermes Paynesfield Rd. Outline. Erection of det. dwelling & gge. Objections: constitutes overcrowded development in this area; felling of any trees. (Trees in front under protection order.)
- v. 85/P/0529. Crayford House, Ship Hill. Erection of 4 car garage and portakabin for use as sitting room in connection with main house. Objections: Net. Green Belt & outside recognised development area of village; in addition to existing 3 garages would considerably increase bulk & spread of development on site; faces land forming part of A.G.L.V.
- vi. 84/P/1030 Adj. Kylemore, Paynesfield Rd. Erect. of det. house & gge Details of garage siting & design. No Action.
- vii. 85/P/0342 St. Elmo, Maesmaur Rd. Demolish existing & erect new bungalow - amended side elevation & inclusion of chimney. No Action.
- viii. 85/P/0543. Siljan, Hillside Rd. Erection of porch. No Action.
- ix. 85/P/0567. Grenville, Old Lane. 2 storey side ext. to provide garage & bedroom over. Dr. South will inspect site.
- x. Appeal. Land at Brackenhurst, Broomlands Lane. Erect. of det. dwelling. Objections to be sent to Dept. of Environment supporting District Council's reasons for refusal.
- xi. 85/P/0565. Motorway Service Area & Associated Works on Approx. 40 acres of land north & south of M25 (Outline). Clacket Lane, Tatsfield. The Chairman read our letter of objections sent to District Council, also report from C.A.T.S.A. Both CATSA & Titsey Estate working hard, independently, to produce good opposition cases. Following lengthy general discussion the following points were made: sufficient environmental study had not been carried out; would construction vehicles get access to site from motorway or Clacket Lane; delivery vehicles & staff cars - access to site; why is service area needed; why is it decided that if you need petrol station & toilets, do you have to have large complex of restaurants etc.; noise. Important factors were adverse fog conditions in this section of motorway and prospect of environment of Tatsfield being ruined if service area built. Traffic would use Tatsfield as through route to rear of service area from London & S.E. suburbs. Residents were urged to send their objections to District Council by July 19th. Agreed to hold Public Meeting in village hall on Monday July 15th at 8 p.m. Leaflets will be distributed to all households advertising meeting.

GFS.

Matters Arising. Planning Applications (Cont'd)

- xi. Appeal, Castleneau, Erect. of 3 houses fronting Old Lane.
Our objections will be sent to Dept. of Environment.
- Dr. South will deal with planning applications for next month.
- b. Crown Road (2Rb) Mr. Payne cleared legal point with solicitor,
regarding claim for use of road as highway.
- c. Footpaths (2 c) Nothing further on:
- i. Footpath Ninehams/Maesnaur Rds. Footpath 564 Crossways/
Westmore Green. Path Through Bluebell Wood.
 - ii. Changes on footpath 21/21A. C. Engineer has completed
consultations on diversion but report to Committee not yet made.
Owner has been requested to remove obstructing fences from
footpaths.
- d. Demolition of But an Ben, Ricketts Hill (2 d) Carried out.
- e. New House by Franklyn, Ricketts Hill (2 f) Erection of bollards.
Nothing Further.
- f. Land between Scrumdoone/Anhedral Greenway (2 g) Possession of Land
Further clearance of land carried out. Garden rubbish reported to
be deposited on land and a 'Parish Council Land' notice defiled
with paint.
- g. Bus Shelter. Vandalism (2 i) Repairs to be carried out 17th July.
- h. Damage to Green & verges (2 j) C. Engineer considers erosion to Green
caused by traffic & surface water run off. Little can be done
to unkerbed highways.
- i. Parish Notice Board (2 k) Maintenance work. Nothing Further to report
- j. Litter & Street Cleansing (2 l) Sponsored Litter collection by Miss
Stevens - 27 sacks collected.
- k. Rydon Homes (2 n) Damage to Westmore Green. Restoration of Green
near swings, will be carried out by Rydon Homes.
- l. Westmore & Tatsfield Greens (2 n) Grass cutting. Will be carried out
as soon as weather permits & machinery repaired.
There is no contract for cutting Tatsfield Green for hay.
- m. 'No Through Road' sign Paynesfield Rd. (2 o) Sign replaced.
Miss Garnham asked whether suitable sign could be erected at
Ricketts Hill end of Paynesfield Rd. to deter possible use as a
'through' route.
- n. Meeting with Planning Officer (2 p) To be arranged.
- o. Screening Trees, Smokey Mountain, Approach Rd. (2 r) Mrs. MCHugo
investigating.
- p. Village Constable (2 s) Meeting to be arranged to discuss matter.
- q. Seaboard Trench across Green (2 t) Re-instatement will be carried out.
Agreed to proceed with Wayleave Consent as amended. Signature
to be with-held until re-instatement carried out.
- r. Numbering of 'Barzeboards' Westmore Rd. (3 c) District Council being
contacted.
- s. Barbed-wire fence (3 d) Alongside section of Tatsfield Lane
Kent C. Council notified.
- t. Rights of Way (4 e) Alleged Public Bridleways - Clarks Lane/
Chestnut Ave. and Kensley/Paynesfield/Ricketts Hill Roads.
Miss Garnham investigating.
- u. Emergency Street Numbering Map (5) Simplified system being considered.

GR

4. Correspondence

- a. Citizens Advice Bureau-Request for Grant.
Agreed unable to assist further this year.
- b. Notice of Extraordinary General Meeting of 'Open Spaces' Society. 9th July.
- c. Biennial National Conference of Local Councillors at Llandudno next April.
- d. Request to nominate Tatsfield School Governor to represent Parish Council for period 1 August 1985 to 31 July 1989.
Our representative will continue to be Mr.Gordon Reeve and hope to be expressed that the Rev.Peter Atkinson can be co-opted
- e. Surrey Public Transport Plan 1985/6. In circulation.

5. Reports

Village Hall. Estimate to supply & erect 2 gates leading into land behind hall - £487.00 + £73.05 VAT.
Agreed to get quotation for 1 gate only. Cost includes clearing site.

6. Accounts For Payment

Solicitor.Interim A/C Crown Rd.	258.75	Prop.Mr.Payne	sec. Mr.Raeve
VAT Refund Village Hall '83/4	284.41	"	" Dr.South
Clerk's Wages July	50.00	" Dr.South	" Mrs.McHugo
" Expenses June/July	8.67	" Mr.Payne	" "
Tatsfield School Fund	25.00	" "	" Mr.Mitchell

7. Any Other Business

- a. Agreed to donate £25 to Tatsfield School Fund in appreciation of Council's use of school duplicator for last 5½ years.
- b. Complaints received over noise caused by clay pigeon shooting.

The Meeting closed at 12.05 a.m.

CRS.
9th September 1985

Minutes of Meeting of Tatsfield Parish Council held on Monday, 9th September '85 at 8 p.m. at Tatsfield School.

Present Miss Garnham, Mrs. McHugo, Mr. Mitchell, Mr. Reeve, Dr. South-in the chair-, Mrs. Player, the clerk and 8 parishioners.
Mr. Dothie, District Councillor also attended.

1. Apologies for Absence received from Mr. Payne.

2. Minutes of Meeting held on 8 July approved & signed.
Proposed by Miss Garnham, seconded by Mr. Mitchell.

3. Matters Arising

a. Planning Applications

- i. Rose Cott. Westmore Green (3a i) Rubble on Green-not removed. Cars reported parked on Green also. Mr. Payne will be asked to investigate.
- ii. Appeal. Land east of Manor House (3a ii) Appeal dismissed.
- iii. Appeal. Porziuncular, Parkwood Rd. (3a iii) Erection dble. gge. attached to front of original. Nothing Further.
- iv. Grounds of Hermes, Paynesfield Rd. (3a iv) Erection det. dwell. and gge. Permission refused.
- v. Crayford House, Ship Hill. (3a v) Erection det. 4 car gge. and portakabin. Permission refused.
- vi. Grenville, Old Lane (3a ix) 2 storey side extension. No Action taken.
- vii. Appeal. Land at Brackenhurst, Broomlands Lane (3a x) Nothing Further
- viii. Appeal. Castlensau (3a xi) Erection 3 houses fronting Old Lane Appeal withdrawn.
- ix. Motorway Service Area & Associated Works, Clacket Lane (3a xi) Further letter stressing our objections sent to all pertinent Councils and other Parties, as before. Reply to be sent to County Planning Chairman confirming our intent to fight for Public Inquiry. District Council will be asked to resist any pressure which may be brought on it to refrain from asking for Public Inquiry.
- x. 85/P/0645 Reconstruction of Granny Flat & Entrance Hall following fire damage. Golden Seal, Paynesfield Rd. No Action
- xi. 85/P/0671 Erection det. house for occupation by Agricultural Worker (Outline) Park Farm, Rag Hill. Same reasoning taken as for previous application-Mins. 10.12.84 item 3a vii) Agricultural land within MGB; outside recognised village development area; area GLV. Opposed to development in this location unless proved necessary for agricultural reasons.
- xii. 85/P/0685. Erection bungalow fronting Chestnut Grove r/o Manara Paynesfield Rd. Objection: Green belt area on fringe of recognised development area; creating area of development between Paynesfield & Ninehams Roads.
- xiii. 85/P/0710 Erection of building - 2 loose boxes & feed store 90 Paynesfield Rd. No Action taken.
- xiv. 75/P/0891. Change of use to Operational Land of Statutory Gas Undertaker. Erection Compressor House & Construction of Service Road (Outline). Former BBC Recept. Station, Beddlestead Lane. British Gas Corporation. S.E. No Action taken.

R.F.P.

Matters Arising (Cont'd)

Planning Applications (Cont'd)

- xv. 84/P/1030 Erection det. house (Amended design) Adj. Kylemore, Paynesfield Rd. - minor modification. No Action taken.
- xvi. 85/P/0751. Demolish porch & erect of new Entrance Hall to link house & ~~sgg~~ Hawthordene, Ricketts Hill. No Action taken.
- xvii. 85/P/0792. Construction of well site & haul rd. Drilling of up to 3 Appraisal Boreholes & testing of any hydrocarbon bearing structure encountered. Temporary plant buildings, equipment & structures as may be necessary. Retention of haul road to assist farming operations. Broomlands Farm, Westerham Rd., Limsfield. Conoco (UK) Ltd. No Action. Mr. Mitchell & Mrs. McHugo will endeavour to visit Conoco site at Palmers Wood, Godstone.

Miss Garnham will deal with planning applications for coming month.

- b. Crown Road (3 b) Matter being reviewed by Surrey C. Council legal dept under Highways Act 1980, also being considered under Wildlife & Countryside Act 1981.
- c. Footpaths (3 c) Nothing Further on:
 - i. Footpath Ninehams/Maesmaur Rds. Footpath 564 Crossways/Westmore Green. Path Through Bluebell Wood.
 - ii. Changes on footpath 21/21A. Mr. Beck, owner of land concerned, has met with representative from Surrey C.C., Parish C. Chairman & some residents, to resolve dispute over proposed diversions. Matter has been resolved & the 2 footpath diversion order applications withdrawn. Application made to place stiles in 2 openings made in fencing on apparent route of 21 & the opening up of path 21A. Discussion took place on present position. Explanation of situation will be given in Parish Magazine & Mr. Beck's efforts to resolve matter will be acknowledged.
- d. New House by Franklyn, Ricketts Hill (3 e) Erection of bollards. Mr. Dohie reported Surrey C.C. unable to take action as no record exists of any previous use of verge by anyone or of any maintenance to verge. Personal approach will be made to owner by Dr. South.
- e. Land Between Scrundone/Anhedral Greenway (3 f) Possession of Land by Parish Council. Land very overgrown.
- f. Bus Shelter-Vandalism (3 g) Some planks have been replaced. Roof needs repairing. Help to be sought from District Council.
- g. Parish Notice Board (3 i) Maintenance work to be carried out. £25 rec'd from Magistrate's Court for recent damage caused by vandalism. This will be repaid to Mr. Tapsell.
- h. Litter (3 p) Sponsored Litter collection by Miss Stevens - £200+ raised for Battersea Dogs Home.
- i. Rydon Homes (3 k) Damage to Westmore Green near swings. Green will be re-instated.
- j. Road Signs (3 m) Suitable sign junct. Paynesfield/Ricketts Hill Rds. under consideration to deter use as possible 'through' route.
- k. Meeting with Chief Planning Officer (3 n) October 29th, Mycenae, Paynesfield Rd. 7 p.m. Items for discussion to be furnished to Mr. Stearne.
- l. Screening Trees Smokey Mountain, Approach Rd. (3 o) Under investigation

R.F.P.

Matters Arising (Cont'd)

- m. Village Constable (3 p) Post advertised - no interest shown so far. Parish Council not satisfied with proposals by Police to cover area by motor-cycle police & for policy to eventually dispose of police houses. Grave concern expressed about extent of crime in village since village policeman left. Mr. Budgen emphasised gravity of situation, his family having personal experience of a severe beating-up; some elderly people afraid to go out at night; parents expressing anxiety about safety of children; reports also of intimidation, cars vandalised & 'break-ins'. Petition will be organised in village stressing need for village policeman to be appointed. Parishioners urged to write to Mr. Carver, Police & Community Liason Group, in Warlingham. Parish Council will express strong feelings of disquiet over situation to Supt. Brent.
- n. Seaboard-Trench Across Green (3 q) Re-instatement will be carried out - The Board is covenanting to re-instate the surface of the trenches in the Deed. Agreement to execute the Deed of Grant between Tatsfield Parish Council and the South East Electricity Board was sought. The action was proposed by Mrs. McHugo, seconded by Mrs. Player and agreed unanimously.
- o. Numbering of 'Bargeboards' Westmore Rd. (3 r) District Council investigating.
- p. Barbed-Wire Fence (3 s) Alongside section Tatsfield Lane. No reply from Kent C. Council.
- q. Rights of Way (3 r) Alleged Public Bridleways. Clarks Lane/Chestnut Ave. - Bridleways Assoc. working on this. Kemsley/Paynesfield/Ricketts Hill - Public Way Evidence forms are being collected. Mrs. Hayes reported some confusion has arisen over actual route.
- r. Emergency Street Numbering Map (3 u) Draft of possible format approved.
- s. Clay Pigeon Shooting (7 b) Letter of complaint received from Mr. Mr. Colin Davis over noise disturbance and nuisance. Enquiries made by Dr. South & Mrs. Player will also investigate.

4. Correspondence

- a. Local Govt. Boundary Commission for England. Review of Non-Metropolitan Counties. In Circulation.
- b. Surrey Structure Plan, proposed amendments. In Circulation
Public Meeting 8th October St. Mary's Church Hall, Oxted 7.30 p.m.
- c. Minutes of Meeting of Police Community Liason Group held 8th July. In Circulation.
- d. Manpower Services Commission. Community Programme. In Circulation
- e. National Tree Week 16-24 November 1985.
- f. Recreation & Leisure Officer - Mr. Stroudly - appointed to this post in Tandridge District Council.
- g. Conoco Planning Application. In Circulation.
- h. Request from Ann Hayes to use land behind hall to school horse. Decision pending.
- i. Request from Mr. Paul Leslie to remove dead timber from wood alongside Tatsfield Green. Mr. Leslie to be referred to District Council.

R.F.P.

Correspondence (Cont'd)

- j. Oxted P.Council offer support for any representations we may make regarding Reviews of Non-Metropolitan Counties.
- k. 'News Release' from District Council - To be published in Parish Magazine if possible.

5. Reports

Village Hall Quotation for 1 Gate & clearing site for erection to provide access into land behind hall accepted - £280 + £42 VAT. Mr. & Mrs. Cooper next door, will be informed P.Council intends eventually to plant hedge round land. Mrs. Mellugo will seek estimates for laying tarmac on frontage of hall. Entertainments Licence being applied for.

Citizens Advice Bureau Sessions in Tatsfield are being discontinued. Number of enquiries made has not warranted keeping open this service.

Village Pond Ducks and duck house have now been added.

6. Accounts For Payment

To supply & erect gate & prepare ground rear of village hall	322.00	Prop. Mrs. Player sec. Mrs. Mothug
Audit of Accounts 84/5	149.50	" "
Mr. Tapsell for repairs to Notice Board following vandalism	25.00	" "
Clerk's Expenses July/Aug	9.72	" "
Clerk's Wages August	50.00	" Mr. Reeve sec. Miss Garnham
" September	50.00	" "
P.W.L. Board. Village Hall & Land	392.84	" "
Hire of Hall C.A.B. June/July/Aug	26.00	" Miss Garnham sec. Mr. Mitchell

7. Any Other Business

- a. Telephone kiosk at bottom of Titsey Hill under threat of removal District Council to be advised of its importance to travellers.
- b. Swings, Westmore Green. Problems caused by their use by older children/young people. District Council to be asked for their advice on erecting suitable notices to deter such use & whether they would have any value.
- c. Mr. Reeve drew attention to the seriousness of the general lawlessness in the village & stressed that good ideas must be put forward now to stop the worsening of the situation.

The Meeting closed at 11.28 p.m.

R. J. Payne
14th Oct 85 / 1985

TATSFIELD PARISH COUNCIL

Minutes of Meeting of Tatsfield Parish Council held on Monday Oct. 14th 1985 at 8 p.m. at Tatsfield School.

Present Miss Garnham, Mr. Mitchell, Mr. Reeve, Mr. Payne - in the chair, the clerk & 15 Parishioners. Mr. Dethie, District Councillor, also attended.

1. Apologies for Absence received from Mrs. McHugo, Mrs. Player & Dr. South.

The Chairman paid tribute to Mr. Harold Tapsell who had died recently & said we were indebted to his service in the village and especially to his work in the village hall and in maintaining the Parish Notice Board. A letter of sympathy had been sent to his daughter and a floral tribute sent from the Parish.

2. Minutes of Meeting held on 9 September approved & signed.
Proposed by Miss Garnham, seconded by Mr. Mitchell.

3. Matters Arising

a. Planning Applications

- i. Rose Cott. Westmore Green (3a i) Rubble on Green - not removed and cars reported parked on Green. Mr. Payne discussed problem with owner, who indicated he would turf this area of Green in next few weeks.
- ii. Appeal. Forziuncular, Parkwood Rd. (3a iii) Erect. dble. gge. attached to front of original. Appeal dismissed.
- iii. Appeal. Land at Brackenhurst, Broomlands Lane (3a vii) Appeal dismissed
- iv. Motorway Service Area & Associated Works, Clacket Lane (3a ix) District Council has recommended that Public Inquiry be held.
- v. Erection det. house for occupation by Agricultural Worker (0) Park Farm, Rag Hill (3a xi) Nothing Further.
- vi. Erection bungalow fronting Chestnut Grove r/o Manara, Paynesfield Rd. (3a xii) Permission refused.
- vii. Construction of Well Site & Haul Rd. Conoco (3a xvii) Broomlands Farm, Limsfield. Site at Godstone visited by Mrs. McHugo & Mr. Mitchell. Noise level appeared to be minimal & other aspects of planning application seemed satisfactory.
- viii. 85/P/0803 Demolish garage & erect new garage with bedroom & shower room/WC above. Tulp Cott. Old Lane. Mr. S. Geary. No Action.
- ix. 85/P/0807 Permanent Retention of Haul Rd. to be constructed to Appraisal Well Site, Broomlands Farm, Limsfield. Conoco(UK)Ltd. No Action.
- x. 85/P/0825 Single storey rear ext. to provide dining room & dormer extensions to provide 2 add. bedrooms & box room. 18 Lusted Hall Lane. No Action.
- xi. 85/P/0856 Re-roofing & construction of 1st floor to provide 3 beds. & bathroom. Elm Mead, Ricketts Hill. Mr. S. Carey, 2 Farm Cott. Biggin Hill. Objection: Bungalow lies on fringe of Green Belt & proposal conflicts with policies set out in Surrey Structure Plan Written Statement 1980 & proposed increase would change category of size of dwelling & reduce stock of smaller dwellings.

Mrs. Player will deal with planning applications for coming month.

R.F.P.

Matters Arising (Cont'd)

- b. Crown Road (3 b) Nothing Further
- c. Footpaths (3 c) Nothing Further on:
- i. Footpath Ninehams/Maesmaur Rds. Footpath 564 Crossways/
Westmore Green. Path Through Bluebell Wood
 - ii. Changes on footpath 21/21A. Official notification of proposed alterations not yet received. Mr. Mitchell suggested sketch of proposed routes could be shown in Parish Mag.
- d. New House by Franklyn Ricketts Hill (3 d) Erection of bollards. Personal approach to owner has not yet been possible.
- e. Land Between Scrumdoone/Anhedral Greenway (3 f) Possession of Land. Land reported to be overgrown.
- f. Bus Shelter - Vandalism (3 f) Mr. Jackson thanked for carrying out repairs with Youth Club. District Council has repaired roof-will be thanked.
- g. Litter (3 h) Sponsored Litter Collection-£212.07 raised for Battersea Dogs Home. Miss Stevens thanked Parish for help received.
- h. Rydon Homes (3 i) Damage to Westmore Green near swings. Further request will be made to have Green re-instated.
- i. Road Sign (3 j) Suitable sign junction Paynesfield/Ricketts Hill Rds. will be considered when matter of alleged public bridleway rights Kemsley/Paynesfield/Ricketts Hill resolved.
- j. Meeting with Chief Planning Officer (3 k) Oct. 29th Nycenas, Paynesfield Rd
- k. Screening Trees Smokey Mountain, Approach Rd. (3 l) Under investigation
- l. Village Constable (3 m) Residents have collected over 500 signatures on petition to Surrey Constabulary asking for village constable to be appointed. Mr. Mitchell met Supt. Brent who maintains crime has not increased recently & re-iterated that policing by motor cycle will be very efficient. Councillors & parishioners present felt there had been an increase in crime & it was related to lack of resident policeman. Following general discussion, it was decided to consider holding a Public Meeting & invite representatives from Police to attend. Another suggestion was to itemise crimes in order to prove our concern. Parish Council will write to Chief Constable of Surrey.
- m. Numbering of 'Bargeboards' Westmore Rd. (3 o) District Council investigating.
- n. Barbed-Wire-Fence (3 p) Alongside section Tatsfield Lane - Westerham Hill end. Kent C. Council will be contacted again.
- o. Rights of Way (3 q) Alleged Public Bridleways. a) Clarks Lane/Chestnut Ave Surrey C. Council to be reminded they authorised double path - footpath/permisive ride & carried out a lot of the work. Path has been in use for number of years. ii) Kemsley/Paynesfield/Ricketts Hill Rds. - 2 ^{completed} Public Way Evidence forms will be forwarded to S.C.C. Mrs. Birch will be contacted to clarify route.
- p. Surrey Structure Plan Proposed Amendments (4 b) Mr. Payne & Mr. Reeve attended Public Meeting. Main effect for Tandridge District - 1600 additional houses have to be found sites for in the 1990s'. Mr. Payne will write in to stress concern over any possible intrusion into Green Belt area between Tatsfield & Biggin Hill.
- q. National Tree Week (4 c) Mr. Reeve pointed out that Surrey C.C. was removing 40 acres of woodland. Decision to plant trees held in abeyance.

R.P.

Matters Arising (Cont'd)

- r. Land Behind Village Hall (4 h) Request to school horse. Decision pending.
 - s. Telephone Kiosk Botton Titsey Hill (7 a) Titsey Foundation will pay £100 p/a for next 5 yrs. to maintain pay phone service. Arrangement confirmed by British Telecom.
 - t. Swings Westmore Green (7 b) Mis-use by young people. District Council confirm our view that provision of Notices restricting their use would be ineffective.
4. Correspondence
- a. District Council News Release Nos. 2 & 3 - Relevant items will be published in Parish Magazine.
 - b. Leisure Mobile Project (District Council) Due to commence April 1986. ? level of support likely. Letter in circulation.
 - c. United Towns Organisation 2nd Conference on Town Twinning 5th-7th Dec. '85. Newcastle, Northern Ireland.
 - d. Imperial Cancer Research Fund - Appeal to help fund by Carol Singing. Letter in Circulation.
 - e. Surrey C. Assocn. of Parish & Town Councils. A.G.M. 2nd Nov. Nominations for Officers sought. Meeting at Pippbrook, Dorking. Mr. Reeve will attend.
 - f. Surrey Voluntary Service Council 35th A.G.M. 17th Oct. at Shalford.
 - g. Village Newsletter Competition run by Surrey Voluntary Council. Parish Magazines may be entered. Passed to Editor of Parish Magazine.
 - h. Councillors' Training Day. 30th Nov. Dorking Halls. Cost £4.50 inc. buffet lunch & glass of wine. Mr. Mitchell will attend.
 - i. Public Consultation - County Library Service. Oct. 17th Council Offices Oxted 4 p.m. Members of public may attend.
 - j. 1st Tatsfield Scouts. Permission sought to hold bonfire/firework party on 2nd Nov. on land behind village hall. Agreed- Proposed by Mr. Mitchell & sec. Miss Garnham. Possibility of Wedding Reception being held in hall on same date will be checked.
 - k. Letters rec'd from owners of 2 plots end of Parkwood Rd. asking Parish Council not to block off access to plots & to have gate removed. Matter will be looked into. Mrs. Randall - Parkwood Cott. - said no objection had been made at time of erection of gate.
 - l. Minutes of last meeting of Tandridge District Parish Councils - passed to Mrs. Mollugo. Next meeting 23rd October.
 - m. South of the Downs Local Plan. Modifications. - In Circulation.
5. Reports
- Village Hall Three estimates have been sought to tarmac frontage.
 - Playing Fields Drains being connected to Fortacabin. Provision of security bars to windows being investigated. Caravan Club Meeting in July 1986

RTP

6. Public 5 Minutes

- a. Mrs. Bradshaw asked whether tarmac to village hall would extend to kitchen door. Mr. Reeve said the two estimates he had sought did not include this area & thought this would be costly as no hard surface existed. It will be ascertained whether Mrs. McHugo's estimate includes this area.
- b. Mrs. Bradshaw reported on litter bins overflowing & drains needing to be unblocked. Necessary action will be taken.
- c. Mr. Barnes referred to planning application by British Gas Corp. for erection of Compressor House etc. (3a xiv last Minutes) & asked if this would result in extra noise.
Mr. Dohie said it was not expected to create any further noise.

7. Accounts For Payment

S.C.C. Hire of School May/June/July	18.00	Prop. by Mr. Mitchell	sec Miss
Floral Tribute Harold Tapsell	10.00	"	" Garnham
Clerk's Expenses Sept/Oct	8.38	"	"
" Wages Oct.	50.00	"	"
S.C.A.P. & T. Councils. Training Day Expenses	4.50	" Mr. Payne	"

8. Any Other Business

- a. Community Transport Officer appointed by S.C.C.-Mr. Burnett. With ref. to Public Transport Plan 1986, from next April tenders will be sought for certain routes, probably including the Tatsfield/Oxted bus. Decisions will be made regarding costs & subsidies by next September. Mr. Burnett can be contacted any time with problems.
- b. Permission given for Tatsfield W.I. to plant further sack of bulbs on Green.
- c. Some parishioners had difficulty identifying King Edward VI Mem. Grd. P. Council agree this should be marked in some way.
- d. Fly Posting. Mrs. Player met Officer from District Council to discuss matter. Agreed Notices should not be put on trees. Question of legality of removing posters will be verified by District Council.
- e. Mayfield Ricketts Hill. District Council to be asked whether all buildings on site are the subject of the planning approval.
- f. Tree lopping Top 0' The Down Ricketts Hill. Mr. Heathfield asked whether it was in order to remove certain trees from frontage. Dr. South & Clerk visited site to discuss matter. Dr. South said P. Council would not object to half dead tree on frontage being removed but other trees should only be lopped at present where branches overhung garden.

The Meeting closed at 11.10 p.m.

RFP

Statement of Income and Expenditure from 1.4.85 to 1.10.85

<u>Income</u>		<u>Expenditure</u>	
Precept (part)	1500.00	Village Hall. Insurance	164.07
Rent for Green	25.00	VAT Refund	284.41
Donation Pond Association	74.56	Erection of gate	280.00
Bank. Interest	191.74	and land clearance	
VAT Refund	342.92	Loan Repayments	392.84
Magistrate's Court	25.00	Hall & Land	
(Vandalism to Board)		General Admin. Post, phone,	95.51
Grant For Pond	312.00	stationery	
		Wages	300.00
	-----	Donations	170.00
	2471. 22	Solicitor(King Ed.&Crown Rd)	285.00
		Subs.	72.45
Bal. of Precept	1722.00	Fencing. Parish Land	896.72
		Pond	790.00
	-----	Hire of School	30.00
	4193.22	Hire of Hall CAB	48.00
Bank A/C Current	208.12	P.C. Insurance	20.00
" Deposit	2294.00	Audit	130.00
		Repairs to Board	25.00

	6695.34		-----
			3984.00
		Refundable VAT	355.76

			4339.76

Estimated committed Expenditure to 31.3.86 850.00

R. J. Payne
11th November 1985

TATSFIELD PARISH COUNCIL

Minutes of Meeting of Tatsfield Parish Council held on Monday 11th November '85 at 8 p.m. at Tatsfield School.

Present Miss Garnham, Mr. Mitchell, Mr. Payne-in the chair, Mrs. Player, Mr. Reeve, the clerk and 7 parishioners. Mr. Dohie, District Councillor, also attended.

1. Apologies for Absence received from Mrs. McHugo and Dr. South.

2. Minutes of Meeting held on 14th October approved and signed. Proposed by Mr. Reeve and seconded by Miss Garnham.

3. Matters Arising

a. Planning Applications

- i. Rose Cott. Westmore Green (3a 1) Rubble on Green now removed. New turf laid & general appearance of area much improved.
- ii. Motorway Service Area & Associated Works. Clacket Lane (3a iv) Draft Orders published for diversion of footpath & provision of access road. Objections to road: would require widening lane & encroach on Clacket Green - common land; increase of traffic in Clacket Lane/Pilgrims Way.
- iii. Erection det. house for Agricultural worker (3a v) Park Farm Rag Hill. Permission granted.
- iv. Elm Mead, Ricketts Hill (3a xi) Re-roofing & construction of 1st floor to provide 3 beds. & bathroom. Nothing Further.
- v. 85/P/0893 Erec. det. 4 bed. house & gge (Outline) Land adj. Meadowside, Paynesfield Rd. No Action.
- vi. 85/P/0928 Change of Use from dwelling to Rest Home, Franklyn Ricketts Hill, Mr. A. Bradshaw. Objections: Commercial use in Green Belt; would create precedence for other houses in area to be used this way; generation of extra parking at site & extra traffic movements on to Ricketts Hill. If planning permission granted, District Council should bear in mind has not been possible to get rid of hazardous bollards outside new house in grounds of Franklyn & applications are linked. It could not be expected by applicant that any proposals for future extensions would be allowed.

Mr. Mitchell will deal with planning applications for coming month

b. Crown Road (3 b) Surrey C. Council Highways, has sent papers to their legal dept. to deal with matter. (Delays due to staff shortages)

c. Footpaths (3 c) Nothing Further on:

- i. Footpath Ninehams/Maesmaur Rds. Footpath 564 Crossways/ Westmore Green - Surrey C. Council to be contacted. Path through Bluebell Wood - Surrey C. Council legal dept. dealing with matter.
 - ii. Changes on footpath 21/21A. Discussion took place on position of stiles proposed to be erected & agreement reached with Mr. Beck-owner. Surrey C. Council will be informed of Parish Council's views.
- d. New House by Franklyn Ricketts Hill (3 d) Erection of bollards. Nothing Further.
- e. Land Between Scrundons/Anedral Greenway (3 e) Possession of Land Clearance will need to be carried out next Spring.

R.P.P.

Matters Arising (Cont'd)

- f. Bus Shelters & Litter Bins (3 f) Damage again caused to shelter in centre of village. District Council will be asked to help with repairs & thanked for repairing roof of shelter on Approach Rd. Possibility of providing litter bin there will be ascertained. Larger litter bins installed in village centre.
- g. Rydon Homes (3 h) Damage to Westmore Green near swings. Mr. Payne will contact company.
- h. Road Sign (3 i) Junction Paynesfield/Ricketts Hill Rds. Suitable sign at Ricketts Hill end to be considered.
- i. Meeting with Chief Planning Officer (3 j) October 29th. Items discussed: Boundaries of built up area in relation to North of the Downs Plan; Green Belt policies; design; and categories for size of houses.
- j. Screening Trees Spokoy Mountain, Approach Rd. (3 k) London B. Bromley to be contacted re planting of screening trees. Question of more land being used for business activities will be looked in to.
- k. Village Constable (3 l) Parish Council invited to meet Chief Supt. Hughes from Reigate, Acting Superintendent Durston, Caterham & Sgt. French, Warlingham. Position of future policing fully explained & previous statements confirmed. Village constable will not be re-appointed. Motor cycle patrols, as planned, should give adequate or more coverage. Residents urged to report all incidents to police, promptly.
- l. Numbering of 'Bargeboards' (3 m) District Council investigating.
- m. Barbed Wire Fence (3 n) Alongside section Tatsfield Lane. Kent C. Council investigating.
- n. Rights of Way (3 o) Alleged Public Bridleways i) Clarks Lane/Chestnut Ave. Completion of Public Way Evidence Forms being sought. ii) Kemsley/Paynesfield/Ricketts Hill Rds. Public Way Evidence Forms should be completed soon. Actual route being clarified with Surrey C. Council.
- o. Surrey Structure Plan Proposed 1st Amendments (3 p) Our comments will be considered before Surrey C. Council makes any formal decision.
- p. National Tree Week (3 q) No decision made for any tree planting.
- q. Land Behind Village Hall (3 r) Request to school horse. Any more than 28 days a year would constitute change of use & present regular use. It would therefore be advisable to refuse request. RP
New Gate into Land. Some nuisance reported of people using gate & clanging shut. Possibility of fitting padlock discussed & reason for gate being used frequently. No decision taken on padlock until further enquiries made as to nuisance caused. Question of providing fencing panels along hedge line as screen for bungalow next door was discussed. Probable cost approx. £50. Parish Council unable to meet cost of erection also. Decision pending on whether to offer full cost of panels to Mr. & Mrs. Cooper, 1/2 cost, or defer until later.
- r. Leisure Mobile Project (District Council) (4 b) To be advertised in Parish Magazine.
- s. Councillors Training Day (4 h) 30th Nov. Mr. Mitchell attending.

RP

Matters Arising (Cont'd)

- t. Public Consultation-County Library Service (4 i) Mrs. Player attended meeting. Suggestion made to have Mobile Library back on weekly basis. Request will be made for Agenda to be sent prior to next year's meeting.
- u. Parkwood Rd. Plots of Land (4 k) Surrey C. Council will be informed of request by owners of plots at end of road, to have gate removed by Parkwood Cott. Suggestion made that gate could be turned round across driveway instead of across road. Mrs. Randall-Parkwood Cott. said gate was never locked & anyone could pass through, no request had ever been made to her before to remove gate.
- v. King Edward VII Mem. Grd. (8 c) Boundaries of land to be marked.
- w. Fly Posting (8 d) Mr. Lawrence, District Council, to be reminded about information promised on legality of removing posters from trees on land owned by Parish. Notices put on telegraph poles are responsibility of Highways.
- x. Mayfield, Ricketts Hill (8 a) Site inspected by District Council. All buildings currently subsisting on site have been erected with full permission and knowledge.

4. Correspondence

- a. Surrey Constabulary. Meeting at Oxted 25th November with District & Parish Councillors to discuss any problems. Mr. Payne, Mr. Mitchell & Miss Garnham will attend.
- b. Nutfield Parish Council. Fighting Fund established against Appeal lodged against refusal for all-weather surface to be laid to existing grass run-way at Redhill Aerodrome. Nutfield seeking support. Agreed by Parish Council to take no action.
- c. Conoco Re: Appraisal Well Site Broomlands. Plans outlined for next few weeks. In circulation.

5. Reports Village Hall. Three estimates received for tarmac to frontage. Agreed to accept estimate of £944.50 + VAT from Starvac. Cost includes area to kitchen door. Timing & restrictions for access to hall during work, to be ascertained.

School Governors Meeting on Nov. 14th. Mr. Reeve asked whether it was Council's wish that the Rev. Peter Atkinson, Priest in Charge, St. Mary's Church, Tatsfield, should be co-opted on to School Governing body. All agreed.

6. Public 5 Mins.

- a. Mr. Hayes drew attention to cars being parked on Westmore Green in Crane Cott. area. Fears expressed this may become acceptable parking area. Mr. Payne will make personal approach to residents in this area. Also, coach is parked on verge near junction Lusted Hall Lane/Approach Rd. Enquiries will be made to Highways.
- b. Mrs. Bradshaw drew attention to bus shelter needing more repairs and to general disorder in village caused by some youngsters.

7. Accounts For Payment

Clerk's Expenses Oct/Nov. 14.12 Prop. by Mr. Payne sec. by Mr. Mitchell
 " Wages Nov. 50.00 " " "

8. Any Other Business

- a. Mrs. Player reported on diversion order from Dec 3th - March 8th including Lusted Hall Lane/Ship Hill
- b. Attention drawn to gubby direction posts on entrance to & centre of village.
- c. Possibility of Possessing triangle of land between Shaw/Westmore Rds. will be looked in to.

Meeting closed at 12.05 a.m.

R. Payne
 9th Dec 1985

Minutes of Meeting of Tatsfield Parish Council held on Monday 9th December '85 at Tatsfield School at 8 p.m.

Present Miss Garnham, Mr. Payne - in the chair, Mrs. McHugo, Mrs. Player, Mr. Reeve, Dr. South, the clerk, 4 parishioners & Mr. Dothie, District Councillor

1. Apologies for Absence received from Mr. Mitchell.
2. Minutes of Meeting held on 11th November amended, approved & signed. Proposed by Mrs. Player & seconded by Mr. Reeve.
3. Matters Arising

a. Planning Applications

- i. Motorway Service Area & Assoc'd. Works, Clacket Lane (3a ii) Objections to Draft Orders for diversion of footpath & provision of access road:- Replies received from Councillor Drake, & Titsey Estate. Secretary of State for Transport to send full reply in due course.
- ii. Elm Mead, Ricketts Hill (3a iv) Re-roofing & construction of 1st floor to provide 3 beds. & bathroom. Proposal amended by reducing ridge height & extension can now be erected as "permitted development" not requiring planning permission.
- iii. Change of Use from dwelling to Rest Home, Franklyn, Ricketts Hill (3a vi) Nothing Further.
- iv. 85/P/1008 Tatsfield Working Mens Club Ext. to enlarge kitchen & form office area. No objections but following comments made:- steps should be taken to avoid disturbance to nearby residents by burning of rubbish, run-off of surface water caused by re-levelling, damage to fences or boundary walls, & inconsiderate parking.
- v. 85/P/0968 Grenville, Old Lane. 2 storey side ext. to provide garage with bathroom above. No Action.
- vi. 85/P/1012. Mr. F.B. Watson. Erec. det. chalet bungalow with gge. Fronting Westmore Rd. Land r/o 1 Paynesfield Rd. No Action -- recognised village development area.
- vii. 84.0169. London B. Bromley. 2 storey side ext. & new dormer in existing building (det. house) Revised roof treatment. The Glen, Cudham Rd. Tatsfield. No Action.
- viii. Appeal. Tulp Cott. Old Lane against refusal for pl. permission to demolish gge. & erect new gge. with bedroom and shower room/WC above. No Action to be taken.

Mr. Reeve will deal with planning applications for coming month.

- b. Crown Road (3 b) Surrey C. Council state: "most of 7 Public Way Evidence forms submitted in '81 do not show extensive period of public use & most are defective. Information provided by our solicitor does not provide evidence of uninterrupted public use for 20 yrs. 1894 Indenture appears to relate to sale of one plot & grants private right of way over land reserved for 'the roads'. No direct evidence of dedication of rights of way over Manor Estate taking place? Copy of letter to be sent to our solicitor & copies of above mentioned P.W. Evidence forms obtained. Suggestion made that Land Search of Gorsey Down Farm/Downe House might prove helpful.

- c. Footpaths (3 c) Nothing Further on: i. Ninehams/Maesmaur Rds., & Path Through Bluebell Wood.
Path 564 Crossways/Westmore Green. County Engineer investigating possibility of providing hard surface.
- ii. Changes in footpath 21/21A. Nothing Further.
- d. New House by Franklyn Ricketts Hill (3 d) Erection of bollards. Nothing Further.

RFP

Matters Arising
(Cont'd)

- e. Possession of Land (3 e) i. 'Hayes pasture' (strip between scrummons & Anhedral, Greenway) Further clearance in the Spring.
- ii. Triangle of land between Shaw/Westmore Rds. & strip of land at intersection of Maesmaur Rd./Ship Hill:
A resolution was proposed by Mrs. Player and seconded by Mrs. McHugo that "in the interest of the inhabitants of Tatsfield, the Parish Council takes possession of the triangle of land at junction of Shaw and Westmore Roads, and a strip of land fronting Maesmaur Road and Ship Hill, outlined in red on the plans attached to these Minutes".
This was agreed unanimously.
The Surrey Mirror & Sevenoaks Chronicle will be given this information.
- f. Bus Shelters & Litter Bins (3 f) Litter bin erected by bus shelter on Approach Rd. Repairs carried out to shelter in village.
- g. Rydon Hopes (3 g) Damage to Westmore Green. Mr. Payne in contact with company.
- h. Screening Trees Smokey Mtn. Approach Rd. & area of land being used to carry out business (3 j) London B. Bromley investigating.
- i. Numbering of Barbed Boards Westmore Rd. & Barbed Wire Fence, Tatsfield Lane (3 i & 3 j) Both under investigation.
- j. Rights of Way (3 n) Alleged Public Bridleways. i. Clarks Lane/Chestnut Ave. & ii. Kensley Rd./Beech Ave./Ricketts Hill, Public Way Evidence Forms in preparation. Suitable road sign junct. Payneasfield/Ricketts Hill Rds. (3 h) to be considered when 'Rights of Way' issue settled.
- k. National Tree Week (3 p) Horticultural Society offered help up to £50 towards any tree planting, also help with Clear-Up days. Ian Robertson will be consulted on suggestion to plant red may trees on Green in front of Wedgwood's development.
- l. Land Behind Village Hall (3 q) Proposed by Mrs. McHugo & seconded by Mrs. Player to buy 3 fencing panels (6'x5') + posts to provide screen for bungalow where our hedge was trimmed near new gate. Proposal carried - 5 in favour & . against. Mr. & Mrs. Cooper to be asked to erect fence between our barbed wire & their boundary. Barbed wire not to be cut.
- m. Parkwood Rd. Plots of Land (3 u) County Engineer states Parkwood Rd. privately maintained over which there are highway rights to extent of footpath. Permission granted in 1983 for erection of gate subject to free passage available for pedestrians at all times. Further enquiries to be made as to vehicular rights to five or more plots beyond gate.
- n. King Edward VII Memorial Garden (3 v) Boundaries to be marked.
- o. Fly-Posting (3 w) Dr. South gave information confirming advice given by District Council. No reply from District Council on legality of removing posters from trees on Parish Land.
- p. Cars Parked on Green (6 a) By Crane Cottage. Mr. Payne contacted person concerned who will try & park elsewhere. Car still being parked - partly on road. Letter to be sent if parking persists. Coach parked on verge near junct. Lusted Hall Lane/Approach Rd. Owner to be advised complaints received from residents & query whether this is temporary arrangement.
- q. Dirty Direction Boards To & In village (8 b) Drawn to attention of Highways Dept.
4. Public 5 Minutes
- a. Mr. Hayes queried whether solicitor had given good service to Council over Crown Rd. issue & whether P. Council was intending Crown Rd. should be a road or footpath.
Mr. Reeve said difficulty with proving footpath was that rd. had been ploughed over during war & then fenced. If it could be proved Crown Rd. was dedicated as a Public Highway this Right could not be taken away.
- b. Mrs. Hayes reported street sign for Maesmaur Rd. had been taken out of ground & left against hedge. - Highways will be informed.

RP

5. Correspondence

- a. Coach parked on verge - Letter from Mr. Glass
- b. Notification of Application for Transfer of Licence - Grasshopper Inn Moorhouse, Tatsfield.
- c. Notification from London B. Broadley - Depositing of rubbish in Hillside Rd. near Car Breakers Yard, Gudham Rd.
- d. Precept Requirements for 1986/7.
- e. Copy of letter sent by Village Hall Management Committee regarding payment for hire of trestle tables.
- f. Letter from Rev. Peter Atkinson requesting Parish Councillor to read Lesson at Carol Service. His position as School Governor representing Parish Council also queried.

6. Reports

Village Hall Tarmacadam work to frontage will commence 16th December.

Tatsfield School Governors First meeting of new Governing Board held Nov. 14th. New Head Teacher settled in well. New School Brochure produced. Meeting recommended that Rev. Peter Atkinson be co-opted on to Board & it is hoped this will be confirmed. Peter Atkinson will be informed of situation & thanked for his services as Governor over last two years.

Civil Defence & Local Disaster Exercise. Tatsfield took part under County Emergency Plan & operated 2 small stations. Skill excellent.

Pond Ducks & House have been moved to winter quarters. Horticultural Society have offered to provide some trees in the area.

7. Finance & Accounts For Payment

Budget & Precept Budget discussed & some amendments made.

It was agreed to Precept for £3931. Further increase than usual allows fund for 1987 elections to be set up also for hedge planting & maintenance work to Parish owned land.

Precept of £3931 proposed by Mr. Reeve, seconded by Dr. South. All agreed.

Clerk's Expenses Nov/Dec 6.85 Proposed by Mr. Reeve sec. by Mrs. Player

" Wages - December	50.00	" Mr. Payne	" Mr. Reeve
Ann Hayes - Land Search	3.00		

Agreed to transfer £200 from current to deposit A/C.

RP

8. Any Other Business

- a. Mr. Dothie drew attention to deterioration of Police House & suggested house could be used for clinic/doctors' surgery. Surrey C. Council to be contacted re leasing house.
- b. Footpath 23. Complaint made on state of path between woods and Church Lane. Mr. Reeve stated tractor had made firm path on this stretch. avoiding ditch by hedge.
- c. Mr. Almond. Whitewood Cottages, had reported difficulty in finding estate in an emergency. District Council has been asked to erect direction board.

The Meeting closed at 12 o'clock

R. J. Payne
13/1/86

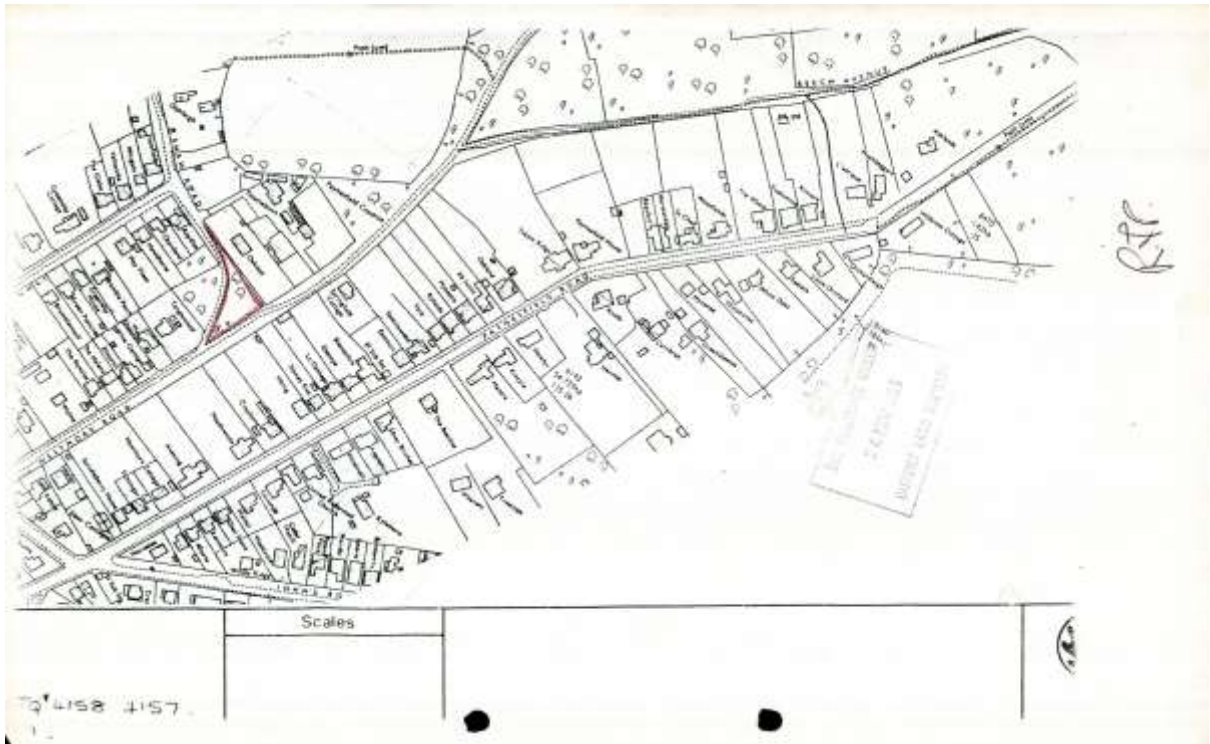

Scales

73 4158 4157
1.

ORDNANCE SURVEY
PLAN REFERENCE

TQ 4156

SECTION G

Scale
1/1250 Enlarged from 1/2500

COUNTY SURREY

DISTRICT TANDRIDGE

© Crown copyright 1975

Plan B

TATSFIELD PARISH

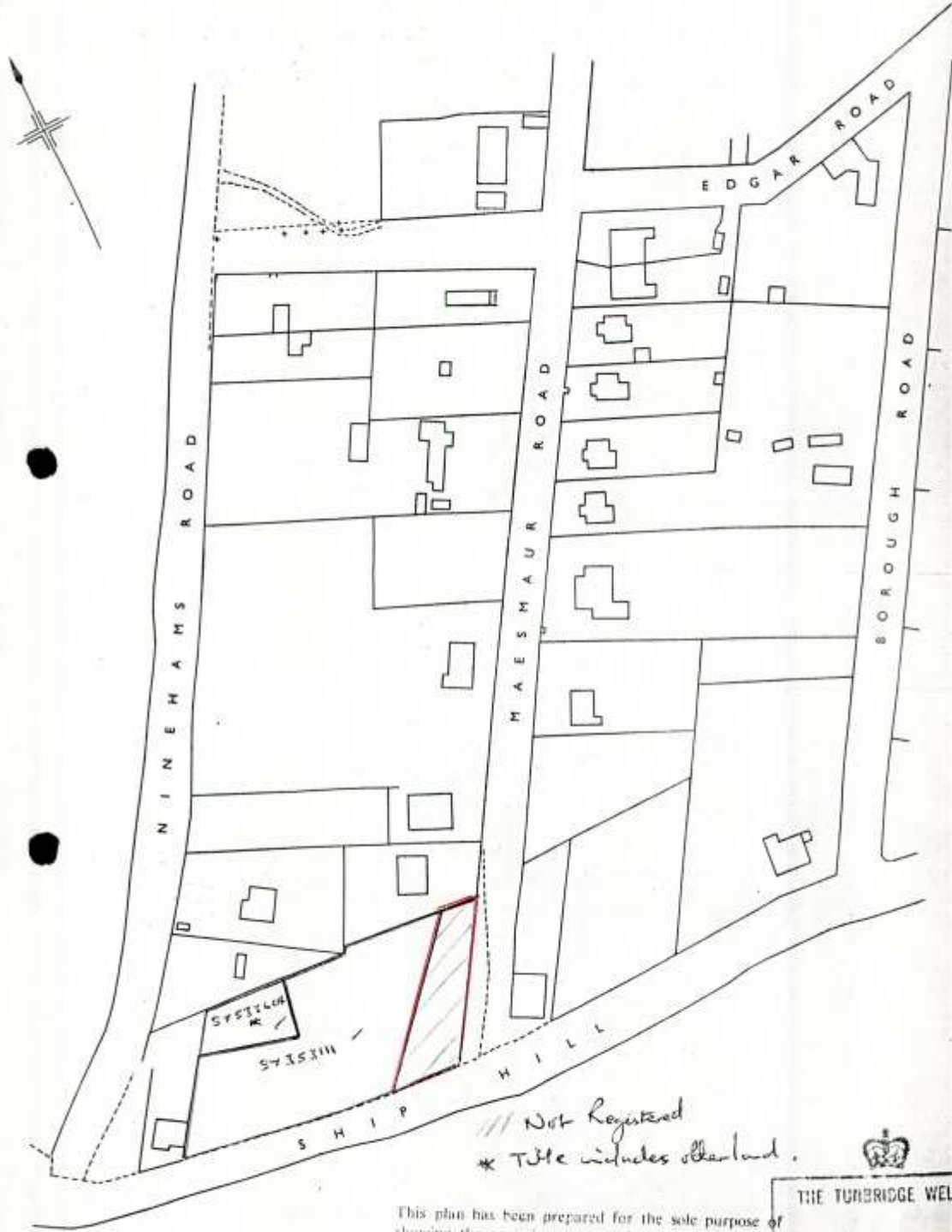

*Not Registered
* Title includes other land.*

This plan has been prepared for the sole purpose of showing the area in respect of which an official search has been made. It is not intended to be used for or relied upon for any other purpose.

THE TUNBRIDGE WEL
 13 AUG 1984
 DISTRICT LAND REGIS

R.T.P.