

Pleshey Parish Guide 2020



Published by Pleshey Parish Council
January 2020

Pleshey Parish Guide 2020

Welcome to the Pleshey Parish Guide 2020.



Whether you have lived here for a while or you've just moved in, the Pleshey Parish Guide is a useful source of information to help you get the most out of your Parish and Community - a guide to the history, services, community groups and facilities of Pleshey.

It has been kindly published by the Parish Council and a printed copy has been provided to each household in the parish. You'll also find copies available in key locations throughout the Parish such as the church and the pub.

You can also view a copy online at **www.pleshey.org**

Cover: Members of the Community of Pleshey and visitors enjoying the Grand Tea at Holy Trinity Church on a day of glorious autumn sunshine

Contents

Welcome to Pleshey	4
A Brief History of Pleshey	5 & 6
Pleshey Parish Council	7
City and County Councils	8
Heritage and Planning	9
Council Roles and Responsibilities	10 & 11
The Leather Bottle	12
Holy Trinity Church	13
Pleshey Village Hall	14
The House of Retreat	15
Footpaths	16 & 17
Pleshey Circle	18
Pleshey Support Group	19
Pleshey Tennis Club	20
Pleshey Carpet Bowls Club	21
Pleshey Choir	22
Pleshey Bell Ringers	23
Flower Arranging	24
Pleshey Community Development Trust	25
Pleshey Parish News	26
Bus Services	27
Little Waltham Surgery	28
Allotments	29
Useful Services	30
Notes pages	31

Welcome to Pleshey

Pleshey has a rich history from the Bronze Age to the modern era. It was the capital town of Essex centred around Pleshey Castle, the former seat of the Earls of Essex. One of whom Geoffrey de Mandeville was a rebel baron and a key proponent of the Magna Carta. The castle is no longer, but the motte and bailey around the castle site is one of the finest in Britain. Pleshey also figured in Shakespeare's writing although it was spelt "Plashey" in those days. In more modern times Pleshey was home to a top secret listening post during WW II.

There are many fine walks around Pleshey, including a circular walk round the defensive outer ditch and along the Essex Way which goes through the village. Because of its history and architecture Pleshey as a whole is classified as a Conservation area. This means that strict planning restrictions apply to both buildings and to trees.

To keep up to date with what is happening in the village please sign up to our excellent monthly newsletter; Pleshey Parish News, great value for money at only 60p an issue. You can also go on line to visit our website www.pleshey.org to access Pleshey Parish Council information. On the social media side of things there are several groups on Facebook: The Leather Bottle Pleshey, Pleshey Village Hall, Pleshey Parish Council and Holy Trinity Church Pleshey. We also welcome any ideas for new activities in the village so if you have any thoughts about running or suggesting activities please come along to a Parish Council meeting and we may be able to help.

Jon Mallender, Chair of Pleshey Parish Council

A Brief History of Pleshey

Pleshey is one of the oldest villages in England.

It was once called Tumblestoun, the town of the tumuli or hills, which was the name it was known in Saxon times. The name Pleshey was given by the Normans who called it “Plessis” or “Plesseis”, an enclosed space. Its outer defences of earthen wall and ditch are still visible around the village some 950 years after they were built.



The old brick bridge linking the Motte to the Bailey

The hills with their moat which joined these works on the south side are probably the work of Saxons or Danes and the conical shaped mount is Danish or Norman. The brick bridge spanning the moat between the bailey and the conical shaped mount is early 15th century and is probably one of the earliest brick bridges in Europe, being unique in this country.

William the conqueror gave Pleshey to Eustace, Earl of Boulogne. When his granddaughter married King Stephen, Pleshey with its castle earthworks became vested in the Crown. King Stephen gave the Manor of Pleshey to Geoffrey de Mandeville, his son William completed the castle in stone.

Another Geoffrey de Mandeville (not of the same line) in 1215 was one of the chief barons who extorted from King John the Magna Carta. Geoffrey himself was killed in a tournament in 1216. Pleshey then passed through marriage to the de Bohuns and in 1380 Eleanor, the heiress of that family, conveyed it by marriage to Thomas of Woodstock, Earl of Buckingham and Essex, later Duke of Gloucester, High Constable of England, and the seventh son of Edward III. Pleshey Castle was his chief seat, but he only enjoyed it for 17 years. In 1397



The Ricardus stone in Holy Trinity Church

King Richard II came to Pleshey and had Gloucester arrested and spirited away to Calais where he was murdered at the King's instigation. Later in the same year the castle and all the Duke's possessions therein were seized by the King. The Royal possession was indicated by an inscribed stone, built over the main entrance, reading RICARDVS REX II. This stone is now in the Church of the Holy Trinity Pleshey where it may be seen by

request to the church wardens. Gloucester was the last Lord of Pleshey known to live in the castle.

Pleshey not only has the honour of being the residence of one of the men who obtained our liberty in 1215, but for 250 years was also the residence of the High Constables of England (Secretary of State for War). In 1393 a Collegiate Church was founded here by Thomas Duke of Gloucester, for nine chaplains. This was suppressed by King Henry VIII in 1546 and sold to Sir John Gates of High Easter, who pulled down most of the college and church and sold the materials. Parts of the present church are the chapel of this college and the rest is the result of a restoration carried out in 1868 by the architect Frederick Chancellor who was contracted to do the work by J. J. Tufnell of Gt Waltham and the then vicar of Pleshey the Reverend J. Hutchinson.

A survey made in 1558/9 found that the castle was in a very ruinous state and some of the buildings were already gone, and the castle along with Pleshey Little Park was bought by Sir Robert Clerke, Baron of the Exchequer, for £33-6-8d (£33.33 pence). This family possessed the castle, college site and tithes and sold them to William Joliffe in 1720, who bequeathed them to his nephew Samuel Tufnell of Langleys in Gt Waltham. A new church school was built in Back Lane in the 1860s by J J Tufnell and was closed in 1937. After World War Two the School became the Village Hall, with a small library. The Hall ran there until 1988 when it was sold and turned into a house.

Pleshey Parish Council

The Parish of Pleshey has a council of 7 people, who have a range of roles and responsibilities in the village.

The Parish Council is non-party-political, voluntary, and has a small annual budget that comes from part of the council tax payments by residents. The Council co-ordinates the care of village assets including the Golden Jubilee Playground, the Mount Viewing Area, and some footpaths, and also supports the work of community groups with financial and non-financial support.



Pleshey Parish Councillors 2020 and their roles:

- Jon Mallender Chair, Village Hall liaison
- Lucy Gunn Allotments
- Stuart Haigh
- Kate Holland Footpaths
- Jill Howeson
- Daniel Kenning Playground, Public Transport, Parish News
- David Loudfoot Planning, Vice-Chair, Emergency Planning
- Will Adshead-Grant Clerk

There are nine meetings a year, usually in the Village Hall. These meetings are open to all residents. Details are published in the Pleshey Parish News and displayed on the noticeboard, next to the post box in The Street.

For further information please contact

Will Adshead Grant, Clerk **T: 01245 360811**
E: plesheypc@gmail.com
W: www.pleshey.org

City and County Councils

Pleshey is in the Rural West Ward of Chelmsford City Council, and the Broomfield and Writtle Division of Essex County Council, and in the parliamentary constituency of Saffron Walden.

Chelmsford City Council operates our recycling, waste disposal services, and street cleaning.

Essex County Council looks after Highways, Education, Healthcare and Public Transport services. Contact numbers are below.

You can also meet your councillors at the regular Parish Council meetings, the Parish Assemblies and at Ward Surgeries in The Leather Bottle. Notices are published in the Parish News.

Councillor and MP contacts

John Aldridge, County Council Member for Broomfield & Writtle Division

Email: Cllr.john.aldridge@essex.gov.uk

Phone: 07827 976997

ECC main: 0345 743 0430



Nicolette Chambers, City Council Member for Chelmsford Rural West Ward

Email: Nicolette.CHAMBERS@chelmsford.gov.uk

phone: 01245 456719

CCC main: 01245 606 606



Kemi Badenoch, MP for Saffron Walden constituency

Email: kemi.badenoch.mp@parliament.uk

Phone: 01799 506349

Heritage and Planning

Pleshey has one of the highest levels of planning protection of any village in Essex, which explains why it's still so lovely, but it means residents must be careful when working on their houses or trees.

This means you will need planning permission for some works that would normally be covered by permitted development, including

- cladding the exterior of the building
- side extensions
- two-storey rear extensions

You will also need planning permission if you want to carry out work to any **tree** in a conservation area.

If you are planning to carry out works on buildings or trees within the conservation area, you should request planning advice from Chelmsford City Council. Listed Buildings team.



Pleshey Conservation Area

For further information please contact:

Chelmsford City Council Conservation and Listed Building Team:
T: 01245 606294

Council roles and responsibilities

The following table shows the roles and responsibilities for the different Councils that have responsibilities in Pleshey and our MP.

See page 8 for names and contacts of councillors and MP.

	Pleshey Parish Council	Chelmsford City Council	Essex County Council	MP
Footpaths	X			
Play equipment	X			
Park benches	X			
Allotments	X			
Defibrillator at the village hall	X			
Annual litter pick	X			
Sports and leisure		X		
Recycling / waste collection		X		
Street cleaning		X		
Fly tipping		X		
Oaklands Museum & Hylands House		X		
Grants to local charities	X	X	X	
Crematorium		X		
Parks and playgrounds		X		
CCTV		X		
Planning		X		
Housing development policy		X		
Highways; potholes, pavements, drains, verges, footpath clearing, hedge cutting			X	

Council roles and responsibilities

	Pleshey Parish Council	Chelmsford City Council	Essex County Council	MP
Bus services			X	
Social and children's care			X	
Schools			X	
Street lighting			X	
Youth services			X	
NHS				X
Pensions				X
Benefits				X
UK-wide tax and national insurance				X
Immigration issues				X
Energy				X
Defence, foreign policy and trade				X
Data protection				X
Rail, air and road transport policy				X
Environment, global warming, flood defence				X

The Leather Bottle



A small, cosy old village pub, a second living room for the people of Pleshey, their friends and families and a welcome stop for thirsty and hungry visitors to the village. For many years the pub was tied to the Ridleys Brewery and it is now a free house run by landlord Rob Reilly and his team.

After the closure of the White Horse, the Leather Bottle is our only pub. After a successful campaign supported by Essex CAMRA, it is registered with the City Council as an “Asset of Community Value”.



Rob serves good beers and home cooked food. The pub is also the hub of many aspects of village life and social events including Morris dancing, folk music nights, quiz nights, entertainment events. The pub also hosts

City Council Ward Surgeries where residents can discuss anything with councillors from Pleshey Parish and Chelmsford City Councils.

For further information please contact:

Rob Reilly, Landord
Facebook:

T: 01245 237291
theleatherbottlepleshey

Holy Trinity Church

Everyone is welcome to attend any of the services and events, or just to simply visit during the day when the church is nearly always open.

There are Holy Communion services every Sunday plus lay-led Morning Prayers, All Age Services, and others. Children are more than welcome at all of the services and there are books etc at the back to keep younger ones entertained. After each of the 10.00am services there is coffee and biscuits in the church and a chance to get to know each other. All service details are published each month in the Parish News and on the notice board outside the church.

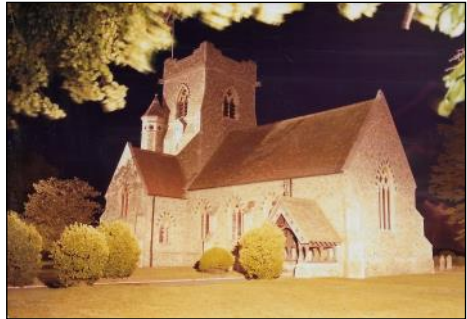

The Priest in Charge is Revd Mike Aston and many services are taken by the ministry team Revd Peter Mason, Revd Jeff Hayward, and Authorised Local Preacher John Bloomer. Anyone living in the village can be christened or married in our lovely church.

The church hosts a number of annual events including a Christmas bazaar every December which is well-supported by the village and offers stalls and lunch and Father Christmas. The famous 'church yard teas' with delicious home-made cakes throughout the summer are always popular with residents and visitors alike.

For further information please contact one of the churchwardens:

Liz Eccles-Williams T: 01245 237237

Rye Mills T: 01245 237115

Pleshey Village Hall



Pleshey boasts an amazing Village Hall with its own playing field. The Village Hall was designed with recreation in mind for its villagers and has two of its own flood-lit tennis courts looked after by Pleshey Tennis Club.

The Village Hall plays host to a wide range of activities for all ages including various health and fitness classes including circuit training, kettlebells and pilates. Some days there is so much going on it's more like an Olympic Village!

The Village Hall is also a venue that supports local groups and clubs such as Pleshey Circle and Pleshey Bowls, serving our local community and playing host to a number of small businesses in the area. It can be hired for private functions including a limited number of wedding receptions and other special occasions.

The management of the village hall is taken care of by a group of local volunteers on the Village Hall Committee, our Bookings Clerk and Cleaner.

For further information please contact:

Annette Pearcy **T: 01245 237530**

E: plesheybookings@googlemail.com

More information can also be found in Pleshey Parish News

The House of Retreat

At the Diocesan Retreat House you will be made welcome to rest, relax and step away from everyday life.



There have been places of prayer in Pleshey since 1396, and a convent was built by the Congregation of the Servants of Christ, dedicated in 1909. The sisters understood the importance of prayer, and when they moved away to Potters Bar in the diocese of St. Albans in 1918, the Diocese of Chelmsford carried on their legacy by creating one of the first Diocesan Retreat Houses, opened in 1919 and bought outright in 1927. In these early years the house was visited by theologians, clergy, writers and retreat leaders - most notably Evelyn Underhill. Evelyn's love for The House of Retreat is well documented as is her fervour for non-clergy being able to access and enjoy prayerful retreats. Following Evelyn's legacy and passion for encouraging people to give time to their personal, spiritual, religious and prayerful growth, the House is open to all, whatever your denomination, including those of no faith.

Chapel: daily prayer led by volunteers, Mon–Sat, 09:00 and 12:15.

Retreats: Individuals and groups visit for day and residential retreats, and the House runs retreats that are open to all. Please see our programme online.

Meeting Rooms: The House rents out meeting rooms, and there two self-contained houses that can be hired for visiting relatives.

For further information please contact:

T: 01245 237251

E: retreathouse@chelmsford.anglican.org

W: www.retreathousepleshey.com, or pop in to the office.

Footpaths

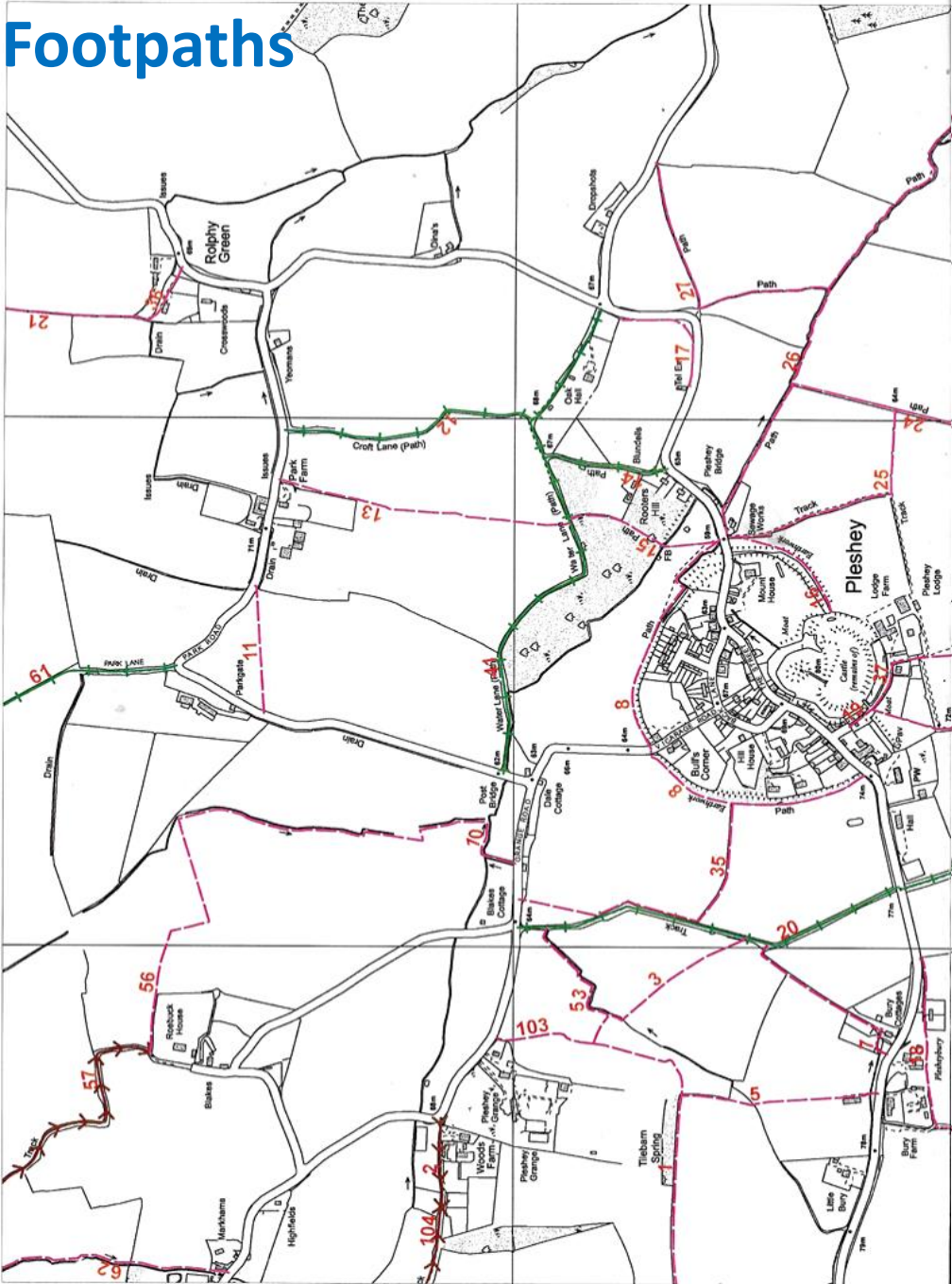



Reproduced by Pleshey Parish Council
 under Licence Number 100060990
 issued by Ordnance Survey
 May 2019

Public Rights of Way in the Parish of Pleshey, 2019.
 The Council has obtained a License from Ordnance Survey to circulate an up-to-date map of public rights of way in Pleshey to every household in the parish; this is provided free with Pleshey Parish News, June 2019, and additional copies are available from the Parish Council.
 Bridleways are in green, footpaths in red and byways in red with red chevrons. Any paths not thus marked are private and not open to the public.

Pleshey Circle

The Pleshey Circle is one of the oldest established social groups in Pleshey, and was at one time a registered charity. It is a social club for anyone in Pleshey and meets every month. Activities include a regular social meeting at the Village Hall or in the Evelyn Underhill Room of the House of Retreat. These meetings often include a guest speaker, and always include a faith tea and cakes! Previous events have included a harvest lunch, Christmas decoration demonstration, and a variety of guest speakers.

Every Christmas the Circle arranges a Christmas lunch, as well as making occasional day trips throughout the year.

The Circle is partly grant-funded by the Parish Council and details of meetings are always published in the Parish News.



The Pleshey Circle at a lunch to celebrate the 50th year back in 2011

For further information please contact:

Chris Curle **T: 01245 363 929**

Jane Smith **T: 01245 353 223**

Pleshey Support Group

Pleshey Support Group (PSG) launched on 1st January 2019 with a core group of local volunteers who are DBS-checked and ready to help people in need in our community.



The aim of PSG is to cover the gap between friends/family assisting people and social services providing professional support, by offering community assistance to those who need it within Pleshey and the immediate surrounding area. Examples include:

- providing lifts to and from medical appointments or clubs
- help collecting prescriptions, library books or shopping
- help with shopping or going out for a walk
- help by sitting in, reading, chatting, writing letters, filling in forms
- other forms of help: please just contact them and ask!

Help from PSG is free and provided by local volunteers. All information related to those we help is maintained as strictly confidential.

A Committee of the volunteers (Clare Martin, Pam Bloomer, Helen Mallender, John Bloomer and Mary Betley) manages PSG, and we rely on grants, gifts and donations for funding. If you would like to know more, please contact one of the Committee members. So if you need help or you know someone who needs help, please contact the coordinators below.

For further information please contact:

Pam Bloomer

T: 01245 237331

Helen Mallender

T: 01245 237099 or 07929158790

Pleshey Tennis Club

Pleshey has a pair of hard courts with floodlights, where the Tennis Club plays regularly. The club organises tournaments, coaching and social events.

New members are always welcome. Membership includes full use of courts all year round, online booking up to 28 days in advance, access to league teams, Wimbledon tickets ballot, weekly club night in spring summer and autumn, and coaching.

The programme of events includes club nights, mini-tournaments, a vintage tournament and a Pimm's night.

The courts can also be booked by non-members.

The website is: www.clubspark.lta.org.uk/plesheytennisclub

Once on the website you can sign in or register which then gives information on coaching , court booking, membership and contacts.



For further information please contact:

Louise Beale

T: 01245 231223

M: 07734 424972

W: www.clubspark.lta.org.uk/plesheytennisclub

Pleshey Carpet Bowls Club

The Carpet Bowls Club is one of the first clubs that used the new Village Hall 30 years ago. The club still meets and regularly competes in local matches, with some considerable success.

New members are always welcome—just come to the Village Hall on a Thursday evening.



For further information please contact:

John Sibley T: 01245 237471

Pleshey Choir

Pleshey is blessed with a choir whose singing and accompanying music well exceed the size of the parish! The talented choristers sing non-religious and religious music, and can be heard singing at many of the main village and church events.

The choir meets to practice every Tuesday evening in the church at 8pm so please do pop along if you'd like to join.



For further information please contact:

Rachel Pritchard T: 01245 237181

Pleshey Bell Ringers

Pleshey has a flourishing band of bell ringers who practice on Friday evenings at 7.30pm and who ring for high days, holidays, weddings and special events.

In 2018 Pleshey's bell ringers won the Essex Association of Change Ringers (SE District) Call Change Competition at Tillingham in their first ever competition!



Great support is provided by the bell ringing team at Writtle Church, where Pleshey's ringers gain excellent tuition and practice.

Pleshey has a ring of 5 bells, unusually laid out anti-clockwise. They sit in a wooden frame which is due for some serious work, so changes are afoot...

Anyone interested in learning to ring is very welcome and should talk to the Tower Captain, Courtney Mandell, or call Lynne Zwink, or come to the tower on a Friday evening when you hear them practicing.

For further information please contact:

Courtney Mandell **T: 07510 301 484**
Lynne Zwink **T: 01245 231 256**

Flower Arranging in Holy Trinity Church

We are a friendly and enthusiastic band of flower arrangers and would welcome anyone who would like to join our team. You do not have to have ever arranged flowers before - we will show you the ropes and introduce you to the mechanics of oasis, wire and tape!



The rota is not onerous. We work in twos which means that we take a turn once in about five weeks and it is not every Sunday that the three regular arrangements – at the High Altar, the Chancel Steps and font plinth - require completely renewing. In the cool of Holy Trinity it is amazing how long flowers last and a rota duty may only involve replacing some flowers and topping up the water.

At big moments in the church calendar – at Christmas, Easter and Harvest – and occasionally for a wedding, we have lots of fun gathering together, as a team, to fill Holy Trinity with flowers including all seven windowsills and the pulpit.



If you would like to share with us the joy of making something beautiful, the opportunity of being hugely creative, and the peace that comes from going into Holy Trinity, closing the door on a hectic life, and becoming totally absorbed for an hour or so just once in a while, please contact Lynne Zwick.

For further information please contact:

Lynne Zwick

T: 01245 231 256

E: l.zwick@btopenworld.com

Community Development Trust

This not for profit organization was established in March 2018 to supplement efforts by Pleshey Parish Council and others to promote a sustainable community in Pleshey. This is achieved by giving grants from the Trust's funds or more likely by helping Pleshey Village community organizations obtain grants from grant giving organizations.

Money is raised through donations and bequests from local residents and grants as well as organising local fundraising events and sponsorships. All ideas and contributions welcome!

All adult residents in Pleshey are eligible to join. There is no annual subscription but any voluntary contribution is appreciated.

There is an annual general meeting every year at the time of the Village Assembly in May to which all are welcome.

The Trustees are: Jon Mallender, Helenmary Stark and Russell Pearcey.

For further information please contact:

Jon Mallender **T: 01245 237099**

Helenmary Stark **T: 01245 237385**

Russell Pearcey **T: 01245 237530**

Pleshey Parish News



A recent front cover celebrating the community with Chelmsford City Council



PPN Team at the reception for winners in the Rural Community Council of Essex village magazine competition. PPN was the magazine from the smallest community, the smallest print run, smallest editorial team and smallest budget.

Pleshey has had a newsletter for over 100 years; a church newsletter until the 1980s, and a parish magazine since.

It has been edited by Mary Horsnell since the 1970s. It is still an independent publication, run by Mary Horsnell, Daniel Kenning and Ian Jarrett.

Pleshey Parish News aims to inform, to entertain, and to strengthen the community of Pleshey, to include as many people as possible, and we try to make it both useful and enjoyable.

PPN is sold for 60p a copy, and the rest of the cost is covered by our stalwart advertisers.

The deadline for copy is always 17th of the month before publication; copy to ppn@pleshey.net or to Daniel Kenning.

Additional copies are available at the back of the church, in the Leather Bottle and in Walthambury Stores.

For further information please contact:

Daniel Kenning T: 01245 237446

E: ppn@pleshey.net (copy)

Ian Jarrett T: 01245 237 432 (subscriptions)

Bus Services

Pleshey has had a bus service for over 70 years. Since deregulation the service has been run privately, under contract to Essex County Council, the Transport Authority.

Most recently the service has been provided by Arrow Taxis, whose contract runs until at least July 2021.

The bus connects Pleshey to Chelmsford bus station, and along the way it calls at Little Waltham Surgery and Broomfield Hospital.



The status of the bus after 2021 is unclear in the context of on-going cuts but the Parish Council will try to protect it.

Bus Times: Service 10, Arrow taxis

Departs Pleshey, Woolmers Mead

Weekdays	09:00	10:55	13:00	15:25
----------	-------	-------	-------	-------

Departs Chelmsford, Bus Station, Stand 9

Weekdays	10:12	12:27	14:10
----------	-------	-------	-------

For further information please contact:

Arrow Taxis

T: 01621 874 410

W: www.arrowtaxi.co.uk

Little Waltham Surgery

The nearest GP practice is in Little Waltham, 4 miles from Pleshey, on the bus route to Chelmsford. There are 8 doctors:



Dr Anjila Agarwal (f)
Dr Dayantha Wijekoon (m)
Dr James Mackin (m)
Dr Sachindev Ramoo (m)
Dr Ann Williams (f)
Dr Joanna Grice (f)
Dr Helen King (f)
Dr Laura Thorogood (f)

The practice operates in Lt Waltham as well as Gt

Notely, and some appointments can be made in either place.

The practice provides a wide range of services with strong emphasis on preventative medicine and promoting good health. To join the practice please bring proof of address (Utility Bill etc) and National Health Service number. You will receive a registration form and Patient Questionnaire, then you will be given an appointment to see the Health Care Assistant for a New Patient Check, and this would complete the registration process.

Children 16 and under can be registered by an adult member of the family by providing the information and signing on their behalf.

For further information please contact:

Little Waltham Surgery
30 Brook Hill
Little Waltham. CM3 3LL

T: 01245 360253

W: www.littlewalthamsurgery.co.uk

Allotments

Pleshey is very lucky to have an area of land in the middle of the village set aside for allotment plots. The allotments are between Back Lane and The Street.

Pleshey Parish Council manages the tenancies but the plots are very ably managed by some of the residents of Pleshey. There are a total of 17 plots but this being Pleshey, they are not all 10 poles or rods (the traditional size of plot) and neither are they arranged in the traditional regimented way but have evolved over the years into a rather pleasing patchwork of cultivation.

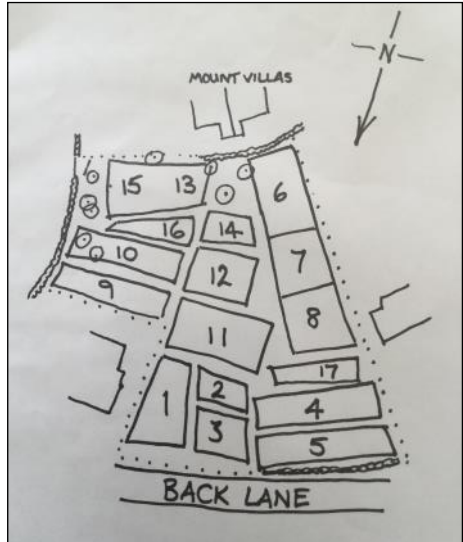

On site facilities are basic which is reflected in the very modest rent. Tenants are obliged to sign a tenancy agreement which outlines what is expected of them during their tenancy. A waiting list is open for anyone who would like either a full or half plot as they become vacant. Please contact the Parish Clerk.

For further information please contact:

Parish Clerk

T: 01245 360 811

E: plesheyipc@gmail.com

Useful Services

Other services which residents, old and new alike, may find useful:

Newspapers: Outstanding News	01279 739357
Milk: Milk and More	0345 606 3606
Recycling collections: (Chelmsford City Council)	01245 615800
Walthambury Stores Gt Waltham	01245 360 278
Highways—to report a problem (Essex County Council)	0345 603 7631

www.essexhighways.org/transport-and-roads/tell-us/problem-check.aspx

Neighbouring village community pages on Facebook, useful for local news such as traffic, lost pets, suspicious vehicles to be aware of:

- Broomfield and The Walthams Community Hub
- High Easter Village Community Group
- Good Easter Village Community Group
- Leaden Roding Village
- White Roding Village
- Chignals & Mashbury Community

Please also refer to Pleshey Parish News for more information and adverts from local suppliers.

Notes page

Emergency Information

 ESSEX POLICE	Police, Fire Ambulance Emerge	999
 UK Power Networks Delivering your electricity	Power cuts: UK Power Networks Ltd	0800 1699970
 anglianwater	Sewage: Anglian Water	0845 682 0170
 ESSEX & SUFFOLK WATER <i>living water</i>	Mains water supply: Essex and Suffolk Water	0345 782 0999
 NHS	NHS non-emergency	111
 ESSEX POLICE	Police non-emergency number	101

Defibrillators

If the 999 call centre decide that you need a defibrillator, they will give you instructions for getting and using the defibrillator, and they will stay on the line to help you.

In case of emergency the village defibrillators are located at:

The Village Hall
The Leather Bottle

Always dial 999 first!