

Our 'journey' to
providing better
facilities along the
Road to the Isles

Road to the Isles Facilities Group

Who are We?

We're a partnership formed by the three Community Councils, Mallaig, Morar and Arisaig, and the Mallaig and Morar Community Centre Association

We're a SCIO with a two-tier structure

Our members can live anywhere within the 3 Community Council areas, and elect Trustees to govern the SCIO.

Why did we start our project?

The area is hugely popular with visitors and numbers are growing

We still have some single-track stretches of road, and a lack of parking

This led to the Community Councils producing a paper entitled 'Seasonal Tourism Pressures'

Existing facilities are inadequate for the volume of visitors

We saw an opportunity to provide a service and generate funds

The Opportunity

Rural Tourism Infrastructure Funding announced, and LEADER funding was available

Highland Council consulting on charging for car parking locally and providing 'community benefit' from the funds generated

Community Empowerment Act

Support from our local MSP and chance to take advantage of momentum generated by 'Seasonal Tourism Pressures' paper

The Project

New off-grid toilets at Traigh Beach

New Toilet Block with Showers and campervan facilities (including grey water / chemical waste emptying and fresh water)

Initially we wanted to include facilities at Morar but this will be Phase 2!

Responses to the Survey

- Campsites are often full and we need somewhere to get rid of toilet waste safely and take on fresh water
- A drive through point allowing grey water, chemical toilet and rubbish disposal would be of great benefit and would ensure the environment doesn't suffer from irresponsible visitors actions. A shower block would also be a welcome addition.
- Initially there are nowhere near enough parking spaces for motorhomes, especially larger ones. Grey water and chemical waste points would be such a forward thinking asset to your beautiful area, and encourage more acceptable behaviour from the minority of thoughtless, selfish motorhomers.

Proving our Case

- Photographic evidence of the issues!



Traigh Beach



- Existing toilet block closed a number of years ago – didn't meet modern standards for waste
- Right next to road so very busy in summer, with lots of 'wild camping' and campervans

The Challenges

- The area outlined Green is what we need
- The Area in pink is what Highland Council own and can lease us!
- No-one is sure who owns the grey area!

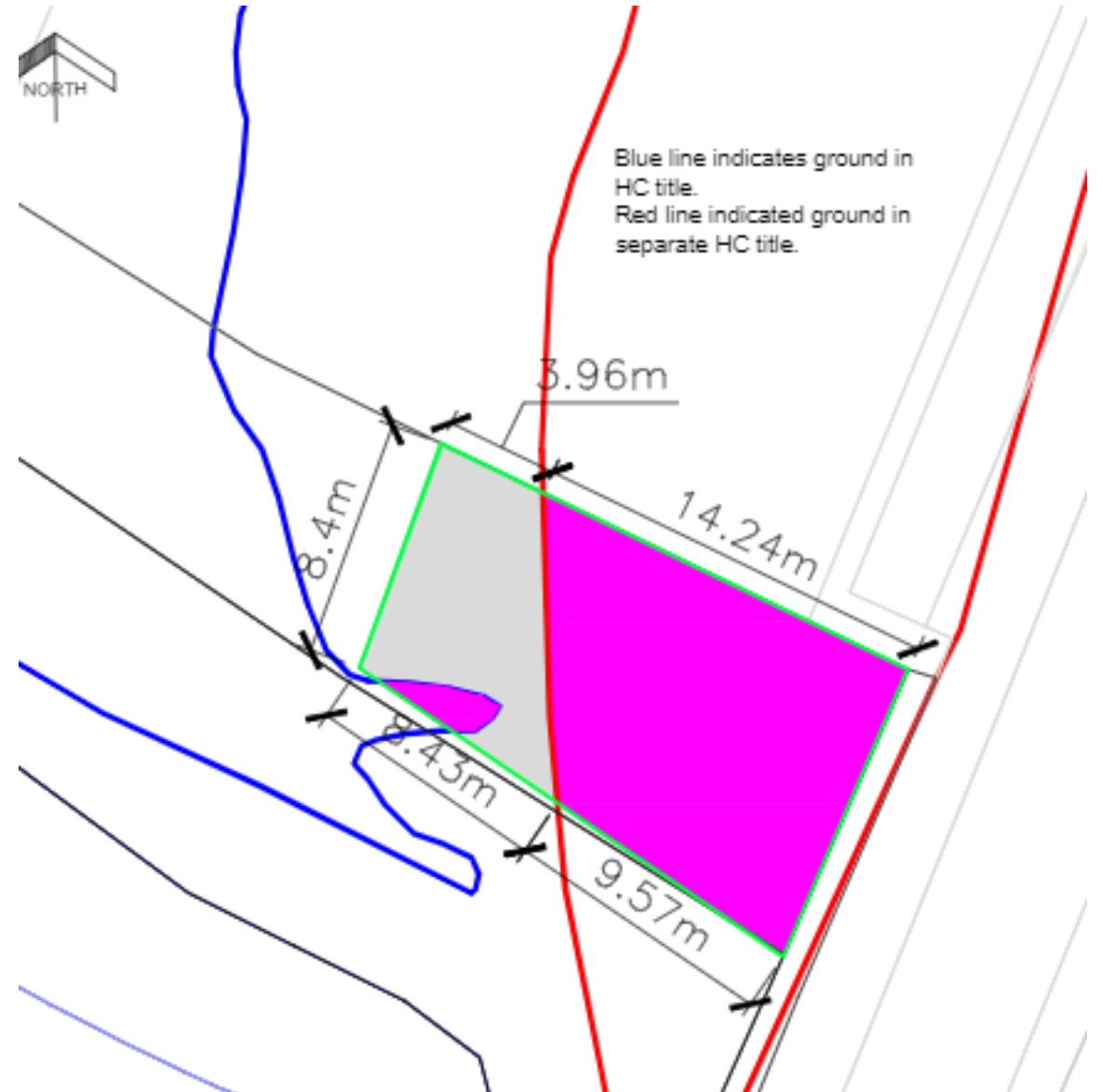

The Positives

The wider community is working together to address an issue that affects everyone

We have the funding we need to make the project happen

We now have a vehicle which is not specific to any of the individual villages and can deliver wider benefits

We've learned a lot along the way!

We already have another project in the pipeline – to deliver a playpark!

Lessons Learned

Communicate

Keep your community informed



Innovate

Be prepared to find a way over hurdles



Delegate

Delegate tasks to those with appropriate skills and experience



Persevere

Never give up!

Thank You

Any Questions?