

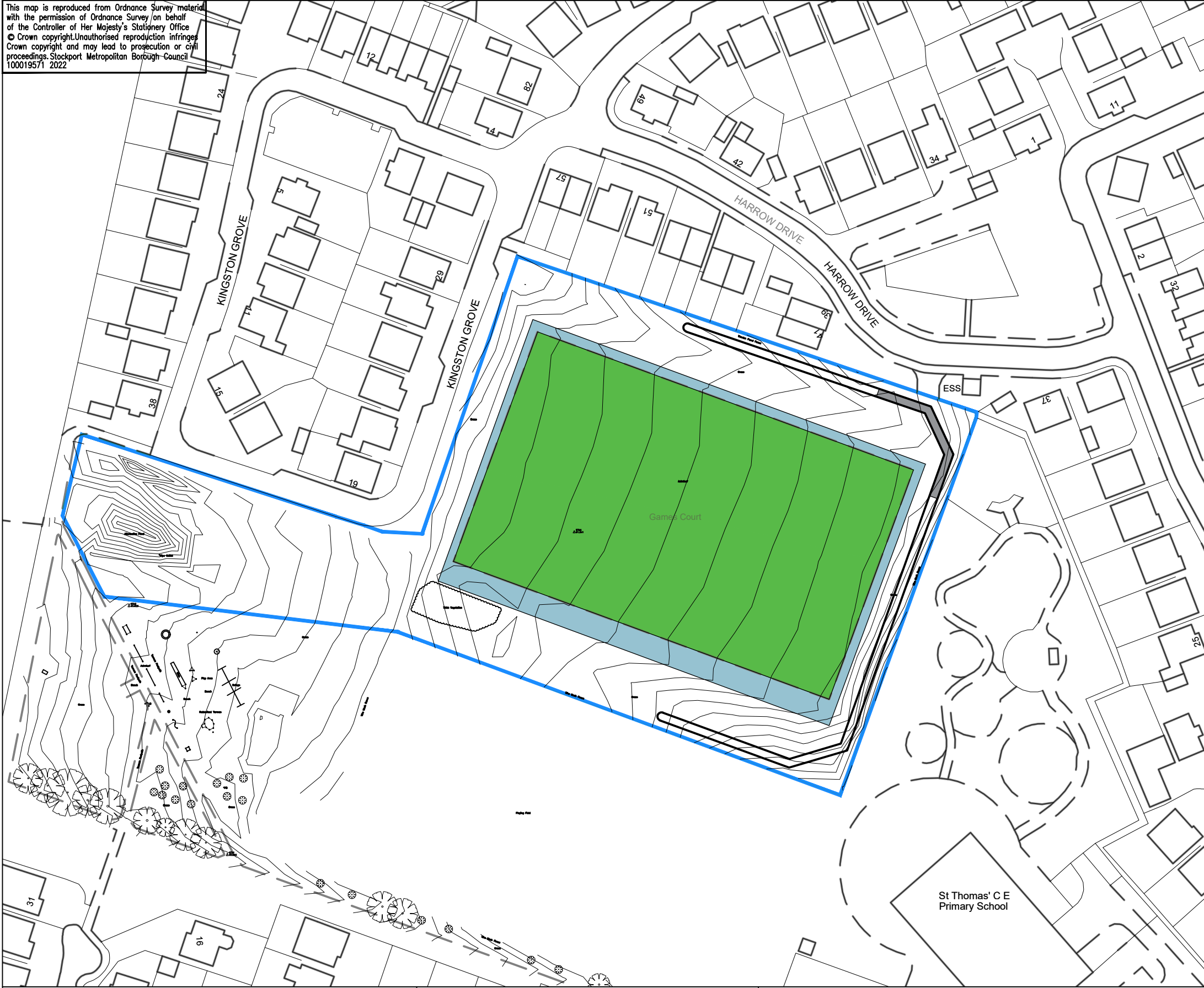





This map is reproduced from Ordnance Survey material with the permission of Ordnance Survey on behalf of the Controller of Her Majesty's Stationary Office. © Crown copyright. Unauthorised reproduction infringes Crown copyright and may lead to prosecution or civil proceedings. Stockport Metropolitan Borough Council 100019571 2022

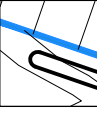

-  Works Boundary
-  Existing path to be retained
-  5620m2 Existing pitch to be overlain with 300mm well firmed depth of topsoil and seeded with amenity sports turf mix seed at suppliers suggested rate.
-  Smooth sided ditch. 500mm deep. 2m wide at top and 1m wide at bottom. remove top 100mm and cart to tip. Retain and spread remaining excavated material on the pitch
-  Smooth sided ditch. 500mm deep. 2m wide at top and 1m wide at bottom. remove top 100mm and cart to tip. Retain and spread remaining excavated material on the pitch lay 200mm dia. perforated pipe and backfil to level with DOT type 1

FOR FEASIBILITY



STOCKPORT
METROPOLITAN BOROUGH COUNCIL
HIGHWAYS AND TRANSPORTATION
STOPFORD HOUSE
STOCKPORT SK1 3XE
Tel : 0161 474 4425

AMENDMENTS				
DRAWN	CHECKED	DATE	No	AMENDMENT
XX	XX	XX.XX.XX	A	XX

JOB TITLE
PEEL MOAT OPEN SPACE

DRAWING TITLE
PROPOSED WORKS

Drawn RN	Engineer RN	Checked PWC	Approved AV
Date 07/09/2022	Date 07/09/2022	Date	Date
Scale 1:1000			
Drawing No. C_3000_003			Revision