



Paths

The plots were laid out in a grid pattern of roadways each boarded with concrete edging stones. Many of the stones remain although often covered with soil and growth which has restricted the width of the roadways and made it more difficult for us to navigate the site. The width of the original pathways is 12 feet, just over three metres.

*Imagine how smart the site would look if we could see the original width of the tracks.
If you have a roadside plot, can you find the boundary stones on your trackside and cut back the overgrowth to the original track.*

The paths were made wide enough for a delivery of manure which came at various times from the Norwich Cattle Market (now a site occupied by the Castle Mall shopping centre).





The Trading Hut

The Bluebell Model Allotment Association was founded in 1926 two years after the completion of the site but they did not achieve sole occupancy of the trading hut until 1944 when the City Council Parks Department finally stopped using it to store their tools.

In the centre of the hut is the pot bellied stove marked with the trade name 'Romesse' It is believed that it was installed at the time when the hut was built. It still works and keeps the volunteers warm in winter. Old Romesse stoves of this type are sometimes available for sale on the internet.



CITY of NORWICH

BLUEBELL MODEL ALLOTMENTS

Scale 100 ft to 1 Inch

ALLOTMENTS SUPERINTENDENT
NORWICH FEB. 1941.

Huts

2972 mthelind

Site Map of 1941

Map of 1941 Shows the whole site, north and south, with the trading hut.
Note that the paths running north to south on the site do not run straight through, as they do today. They appear to have a turning area.
The huts for individual plots are very faintly marked in the map.

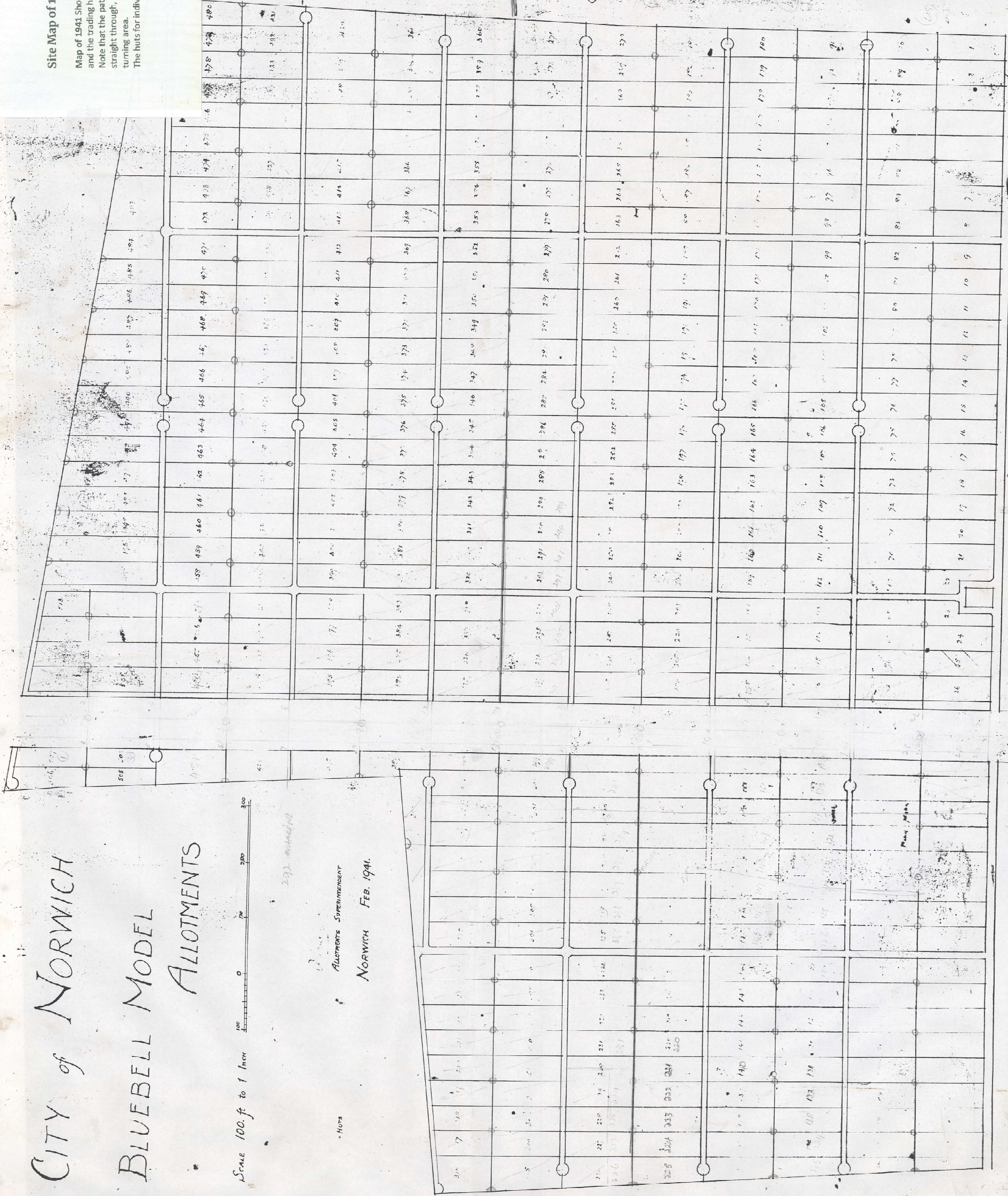



Norwich Corporation Allotment Committee Minutes April 1924

"The Parks Superintendent submitted a statement showing that the number of plots provided by the Bluebell allotments was 513, less 30 which would be required for the above mentioned road (The Avenues) 483 to be let, 311 already taken 172 still vacant."

Site maps

If you look at the maps of north and south sides together you will notice the numbering system starts at the end of the tarmac path nearest Earham Road with plot 1. It stops at number 24 on the tarmac road. The numbering then jumps to the South side with number 31.

That's strange! Why the gap?

When the allotments were laid out by Sandys-Winsch it was one site. However, the City Corporation decided to insert The Avenues and Sandys - Winsch had to remove the marked plots, the trees and allotment huts, but the numbering stayed the same.

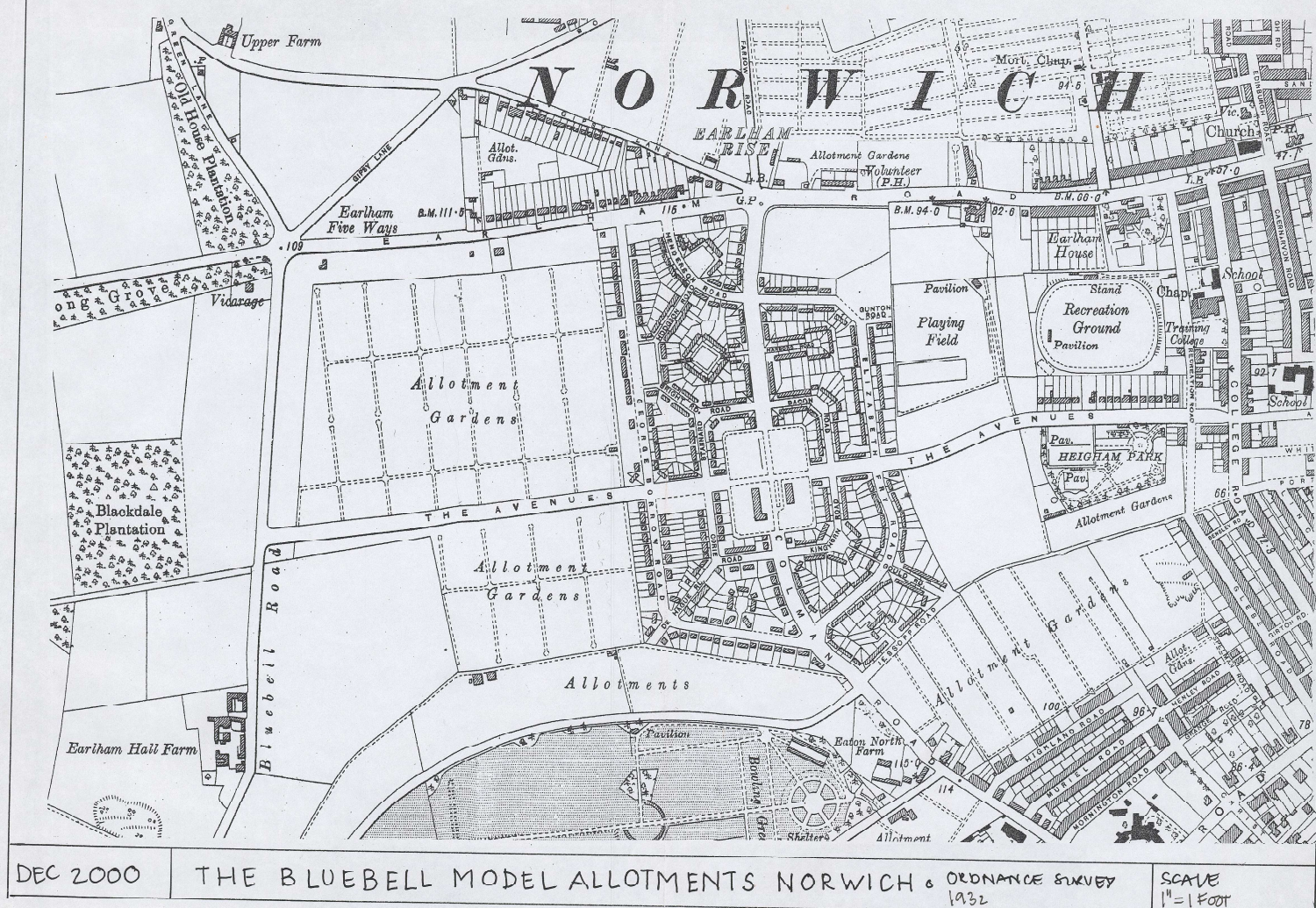

Boustrophedon
turn like an ox ploughing

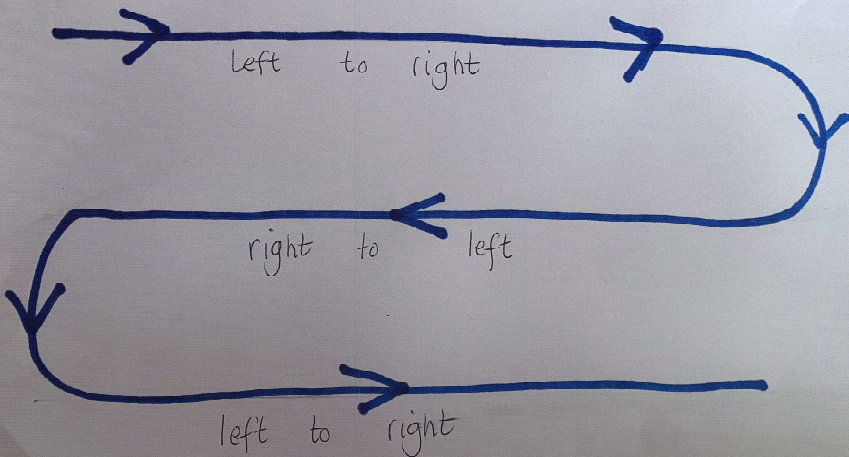

Numbering of plots

Have you ever wondered about the numbering system on the site and why it is not like that of a road or street?

The numbering system is called **Boustrophedon**.
Encyclopaedia Britannia: "the writing of alternate lines in opposite directions, one line from left to right and the next from right to left. The word is from the Greek *boustrophēdon*, meaning literally "to turn like oxen" (in ploughing)."

On the next visit to your plot, see if the numbering of your side of the track is left to right or right to left? On the other side of the track it will be the opposite way round.



"To watch the corn grow, or the
breathe over the plough or spade;
are the things that make men
happy." - John Ruskin