

**MINUTES OF THE BOWERS GIFFORD AND NORTH BENFLEET
PARISH COUNCIL MEETING
HELD AT THE BENBOW CLUB BOWERS GIFFORD
ON WEDNESDAY 30th NOVEMBER 2016 AT 7.30 p.m.**

PRESENT:

Councillors: R.Smillie: B. Foster: N.Tyler

Parish Council Clerk: Mrs Christine Barlow

Residents present: 9

94/16 Apologies for absence: Councillor Sheelagh Pegg and Councillor Terry Potter.

95/16 Declarations of member's interest – To receive any declarations of disclosable pecuniary interests, other pecuniary interests or non-pecuniary interests by members relating to any agenda items.

Here were no declarations of Interest received.

96/16 Draft Local Plan: To receive and update of the process of the Draft Local Plan including the current Basildon Council's New and Alternative Sites Consultation.

(i) Basildon Council's New and Alternative Sites Consultation 2016:

Carl Glossop, Basildon Council Principle Officer, advised the meeting on the background of the Local Plan and the purpose of Basildon Council's New and Alternative Sites Consultation which was now in the public domain. This consultation would close at 23.59 on 15th December 2016 and once all comments had been considered the previous draft of the Local Plan would be updated and a final consultation with statutory bodies undertaken. The meeting was advised that providing the housing numbers proposed were comparable with those in the initial draft of the Local Plan consideration would be made to the alternative locations. The purpose of the consultation was to determine the most appropriate site for the benefit of all concerned. Residents present commented on the issues of (i) flooding (ii) infrastructure and (iii) impact on the centre of the village in the current draft proposals regarding Little Chalvedon Hall Farm.

(ii) **Basildon Council Waste & Recycling Service Consultation 2016:** An Officer from Basildon Council to discuss proposals in regard to the consultation.

James Hendry, Waste & Recycling Manager, gave an overview on Basildon Council's current Waste & Recycling Service Consultation. The meeting was closed by the Chair to allow residents to comment on the proposals. Concerns were raised regarding (i) green waste collection (ii) frequency of proposed black

sack collection (iii) providing bins for recycling material instead of pink sacks (iv) the cost of the changes and (v) increases in bonfires and fly-tipping.

97/16 Public Forum: To enable residents to raise issues of concern with Parish Councillors (The time allowed for this item is 15 minutes)

The meeting was opened to enable residents to raise issues and receive comments.

- (i) Fly-tipped material had been deposited in the middle of the Sadlers Farm roundabout. The Clerk advised she would log a report on the Essex County Council website and asked residents to do the same.
- (ii) A resident complained traffic approaching Sadlers Farm roundabout from the A13 was unable to access the roundabout at certain times of the day because of traffic congestion and it was suggested that another yellow box would solve this problem. Councillors felt this would not solve the problem and would create problems elsewhere on the roundabout. They considered that Essex County Council should review the complete layout of Sadlers Farm and had suggested this to Essex county council on several occasions via the Local Highways Panel.
- (iii) Enquires were made regarding Basildon Council's Mobile Tip Service. The Crunch Service would be in Westlake Park on 3rd December between 9.00 and 12.00 noon. The service would take all household rubbish and green waste but not batteries, paint or other liquids. Information was on the Parish Council website and the Basildon Council website.
- (iv) It was noted there had been a number of burglaries in recent months in Westlake Avenue.
- (v) Councillor Smillie advised he was against fining all residents for misusing the recycling service but considered a programme of education was a better option.

98/16 Minutes of Parish Council meeting held on Wednesday 26th October 2016: Council to approve the accuracy and content of the minutes of the previous meeting and the Chair to sign.

The minutes of the previous meeting on 26th October 2016 were approved as an accurate record of the meeting and were signed, as such, by the Chair, Councillor Smillie.

99/16 Policing update: To advise Councillors of any information received regarding policing activity within the Parish.

An email had been received on 29th November from Sergeant Alan Burrige of the Basildon Community Policing Team acknowledging contact by the Parish Clerk and advising further contact to discuss matters would be made the following week. An email had also been received on 14th November from Terry Fowles, Essex Watch Liaison Officer, advising that Pitsea South East

Neighbourhood Watch was under new management and the Parish Councils request for information would be passed onto the ward co-ordinator but to date of the meeting no contact has been received.

100/16 Parish Clerk's Report: The Parish Clerk to report and update on Parish Council business since the last meeting.

Essex County Council had advised that due to a fire in the underpass at the far end of Old Church Road it would be closed for six months from 6th December 2016. Notification of this had been displayed in the Parish Council noticeboards and the website.

Estimates had been obtained to repair the net swing in Westlake Park and these will be forwarded to the Parish Council's Insurers as part of a claim.

Emails have been received from concerned residents regarding the illegal occupation in the plotlands.

The Parish Clerk had met with Essex County Council Youth Workers regarding the continuation of the Youth Bus. The Youth Bus activity would temporarily cease on 1st December until March/April 2017. Over the winter months it was hoped more volunteers could be recruited to help support the activity.

Winter Salt to spread on roads within the village not covered by Basildon Council gritters during icy conditions was available to residents from 1st December and could be collected from 245 Pound Lane.

Basildon Council Planning Enforcement Training on 13th December was available for a representative of the Parish Council to attend. Councillors were asked to contact the Parish Clerk.

Two enquiries had been received from residents regarding the Parish Councillor vacancy.

The Parish Council has been working with Basildon Heritage and Basildon Council to obtain estimates to install a Talking Bench, donated by the Essex Records Office, in Westlake Park. Three quotations had been received ranging from £360 to £800. The bench included a built in solar powered recording system and carried five (5) different stories, dictated and read by local people, capturing village life during the 40's. A commemorative tree to mark the life a soldier, who lived in the village and died at the Somme, would also be planted in the Park.

101/16 Finance Report: To report on the Council's current financial position and other applicable financial matters.

Christine Barlow, Parish Clerk/Responsible Finance Officer, presented a report on the Parish Council's current financial position and the cheque payments were **AGREED**.

	£
Balance at bank 25 th October 2016	13,625.39
Balance at bank 22 nd November 2016	12,019.20
Payments	
Parish Council Insurance Renewal	589.71
Newsletter Printing & Design	395.00
Clerks Net Salary (inc. Office use)	<u>621.48</u>
	1,883.91

Income : Nil

There were no matters arising from the report.

102/16 Planning - Councillors to review and comment on Planning Application/s under the Town and Country Planning Act 1990 (as amended)

**TOWN AND COUNTRY PLANNING ACT 1990 - APPLICATION NO:
16/01424/FULL**

Demolition of existing bungalow, and erect replacement detached dwelling, detached double garage and stable block (Revised scheme) – Sunnyside, Lower Avenue, Bowers Gifford, Basildon

Councillors considered that although the garage was set back in compliance with BAS GB3 it was of an unusual design and incorporated an excessive ridge height for use as a garage. The garage footprint with a lower ridge height would, however, be acceptable.

The proposed new main dwelling is above that normally permitted under the saved policy BAS GB3. The size of the stables is larger than would in normal circumstances be associated with accommodation used to stable two horses and the ridge height of both the main dwelling and the stables is greater than would be expected. Councillors considered the application to be imposing and detracted from the openness of the area and the overall proportions of the development were excessive, There were no exceptional circumstances which would allow a development outside the normal accepted constraints to be granted and under these circumstances Councillors considered the application should be refused.

**TOWN AND COUNTRY PLANNING ACT 1990 - APPLICATION NO:
16/01391/FULL**

Erection of four bedroom chalet, replacing existing two bedroom bungalow - 7 Page Road, Bowers Gifford, Basildon, Essex

Councillors noted that the applicant was applying for retrospective planning permission having not complied with the previous grant of application to convert the original bungalow at 7 Page Road into a chalet bungalow and having demolished all but two of the original walls of the old bungalow without permission. The new development, although similar in build to other properties

opposite, sits closer to the road and the design of the catslide dormers provide a vertical face looming over the pavement thus giving the appearance to that of a house. Changing the catslide dormers to two separate dormers would significantly reduce the impact of the property on the landscape. However, Councillors considered that the development stepped outside the intentions of the Bowers Gifford & North Benfleet Neighbourhood Plan by its imposing façade and should be refused.

**TOWN AND COUNTRY PLANNING ACT 1990 - APPLICATION NO:
16/01581/FULL**

Rear extension to existing bungalow incorporating changes to the roof profile and dormers (Revised proposal) – Colorado, Burnt Mills Road, North Benfleet, Basildon, Essex

Councillors considered that the footprint of the development would exceed permitted development and would be detrimental to existing green belt policies and design principles and should therefore be refused.

102/16/1 Planning decisions and comments: To receive updates and comments regarding Planning Applications.

None were available.

103/16 Parish Council Budget 2017/18: To receive a report from the Responsible Finance Officer regarding the Parish Council's Budget for 2016/2017 to enable an informed decision to be made in regard to the setting of the Precept amount for 2017/2018.

Councillors received a report on the Council's expenditure for the six months to 30th October 2016 and estimated costs until 31st March 2017. However, Precept calculation figures were not available from Basildon Council as yet and it was **AGREED** to defer this item until the Parish Council meeting on 14th December.

104/16 Old Church Road: To update on measures to restrict access to vehicles.

Following the Parish Council raising concerns that proposals by Essex County Council (3rd October 2016) partially restrict access to Old Church Road did not go far enough and should be restricted to motor vehicles for the whole length of the thoroughfare to prevent frequent problems with fly tipping and vehicle burn outs. Essex County Council have listened to the Parish Council's concerns and revised the extent of the prohibition (illustrated drawing HI4255/1200/003 - attached) and issued a further invitation to the Parish Council to comment on the revised proposal. The proposals now prohibited access to motor vehicles for the entire length of Old Church Road and the plan was to install physical measures to prohibit vehicles at either end but which would still allow access for pedestrians, cyclists and horses. Essex County Council had advised that providing there were no objections to the amended proposals ECC hoped to install a type of gate on Old Church Road near its junction with London Road to still allow access for landowners and that a barrier will be installed at the southern entrance to the underpass. These measures, at either end of Old

Church Road, should prevent future vehicle burnouts and fly tipping.

Action: The Parish Council to respond to ECC within 21 days of the email dated 27th November 2016. Councillors present were all in **AGREEMENT** with the proposals and the Clerk was asked to respond their acceptance accordingly to Essex County Council.

105/16 Neighbourhood Plan: To update on progress

The Council were proposing to meet with volunteers, who had agreed to door-knock with Councillors to obtain the views of residents on the vision for the Neighbourhood Plan, in mid-January. The Parish Clerk was asked to contact the volunteers as soon as a date and venue could be arranged.

106/16 Meetings attended by Councillors: To update on meetings attended by Councillors since the last meeting.

Councillor Foster and the Parish Clerk had attended the Association of Basildon Council's meeting on 17th November 2016 and a response by the Association on Basildon Council's Waste & Recycling Service Consultation had been discussed and agreed collectively by the Association.



Councillor Foster and the Parish Clerk had also attended a Rural Community Council of Essex (RCCE) Neighbourhood Plan coffee morning on 16th November 2016 and exchanged information and views with other Parish Councils and Councillors on the progress of each of their Neighbourhood Plans.

Councillor Smillie had undertaken training to drive the Essex County Council Youth Bus.

103/16 Date of next meeting - To confirm the date of the next Parish Council meeting.

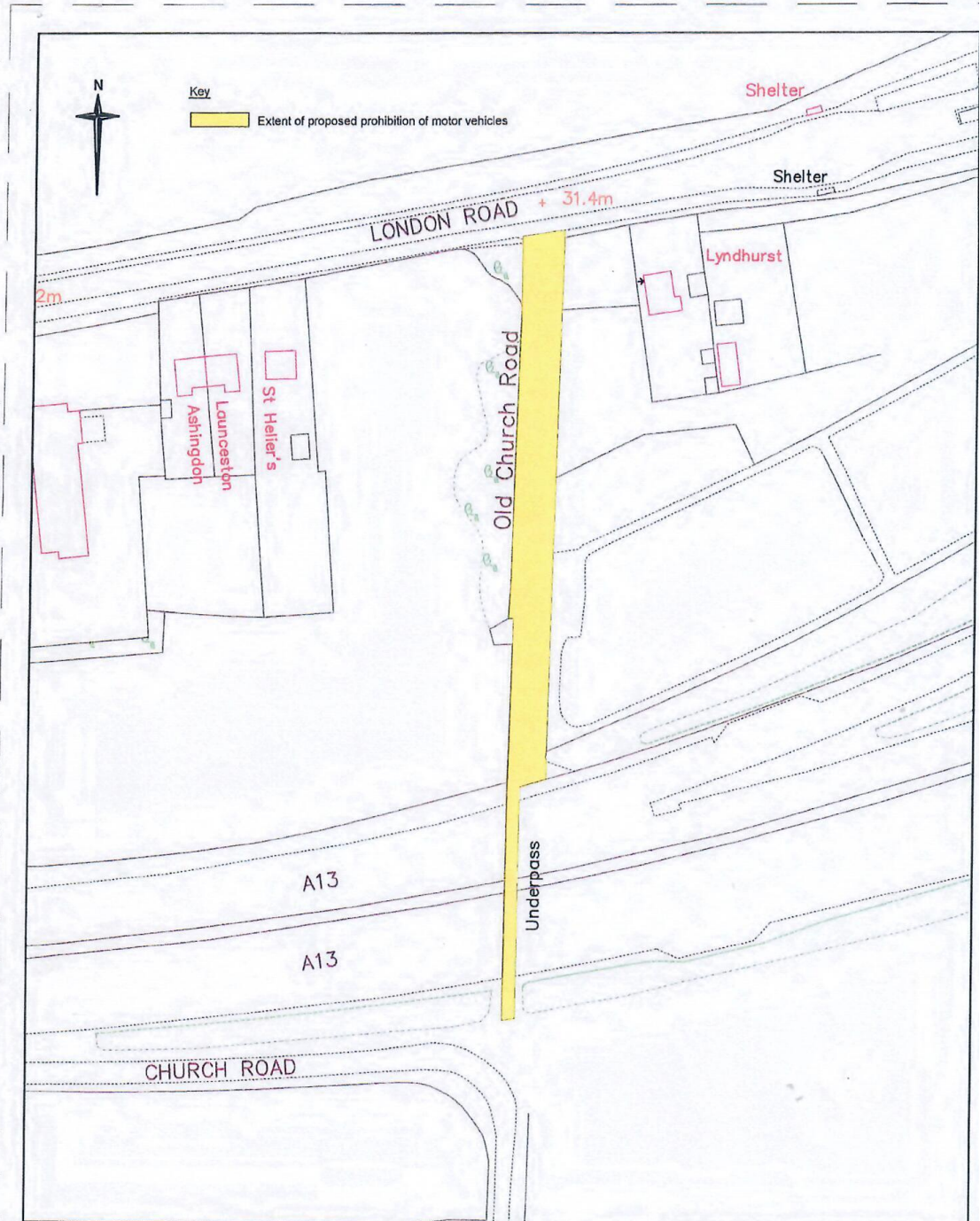
The next meeting was confirmed as 14th December 2016, The Benbow Club, Pound Lane.



 Integrated expertise	 Essex County Council	OLD CHURCH ROAD, BOWERS GIFFORD					CONSULTATION DRAWING			
		PROPOSED PROHIBITION OF MOTOR VEHICLES					Rev C 15	Date Description of revision If rev D is needed remove details of rev A and move the rest down	Drawn XXX	Checked XXX
Mark Rowe, Service Director, Highways Essex House, Victoria Road South, Chelmsford, CM1 1QH. Tel: 0345 5337631 © Essex County Council		DESIGNED AD	DRAWN AD	CHECKED	REVIEWED	APPROVED	DIMENSIONS IN MILLIMETRES LEVELS IN METRES		SCALE AT A4 (210x297mm) 1:1250	
© Crown copyright. All rights reserved. Essex County Council 100018602 2016		DATE NOV 16	DATE NOV 16	DATE	DATE	DATE	DRAWING NO DC1-HI4255-1200-003		REV -	